

2019+ Ranger Grille Light Brackets

Congratulations on your purchase of a high quality PUTCO product. Should you need any application or technical assistance, feel free to call us at: 1-800-247-3974

Monday-Friday 8:00 a.m. - 5:00 p.m. (Central Standard Time)

Contact your PUTCO dealer for other quality accessories.

KIT CONTENTS	
Description	Qty.
Driver Bracket	1
Passenger Bracket	1
1/4" Stainless Washer	2

Tools Needed:

- Sockets: 8mm and 10mm
- Torx T20 and T30 drivers
- Flat head screwdriver
- Trim removal tool
- 5/32" Allen wrench

Installation Instructions:

1. Remove 5x pop clips on radiator shroud (**Figure 1**).
2. Remove 2x T30 bolts on air intake snorkel (**Figure 1**).

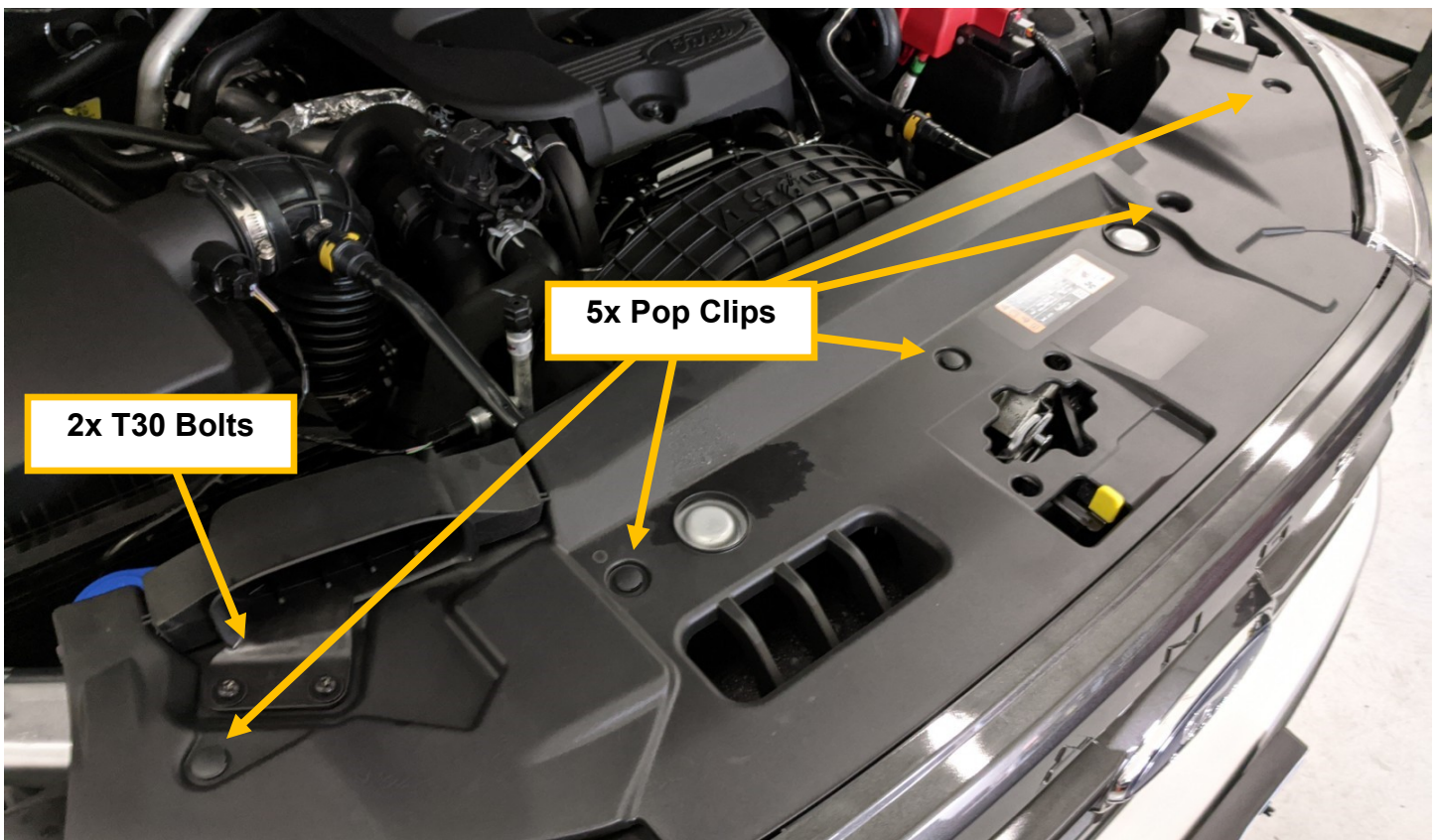
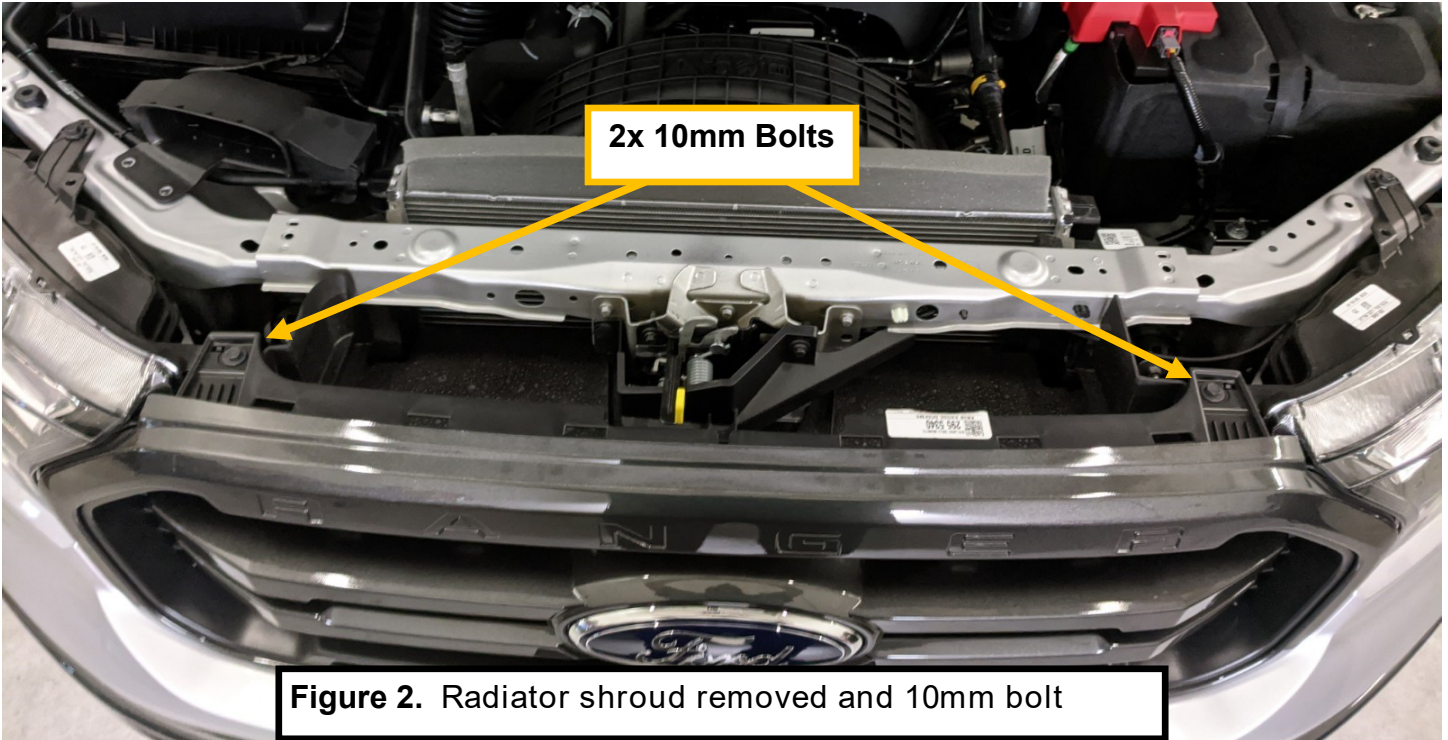
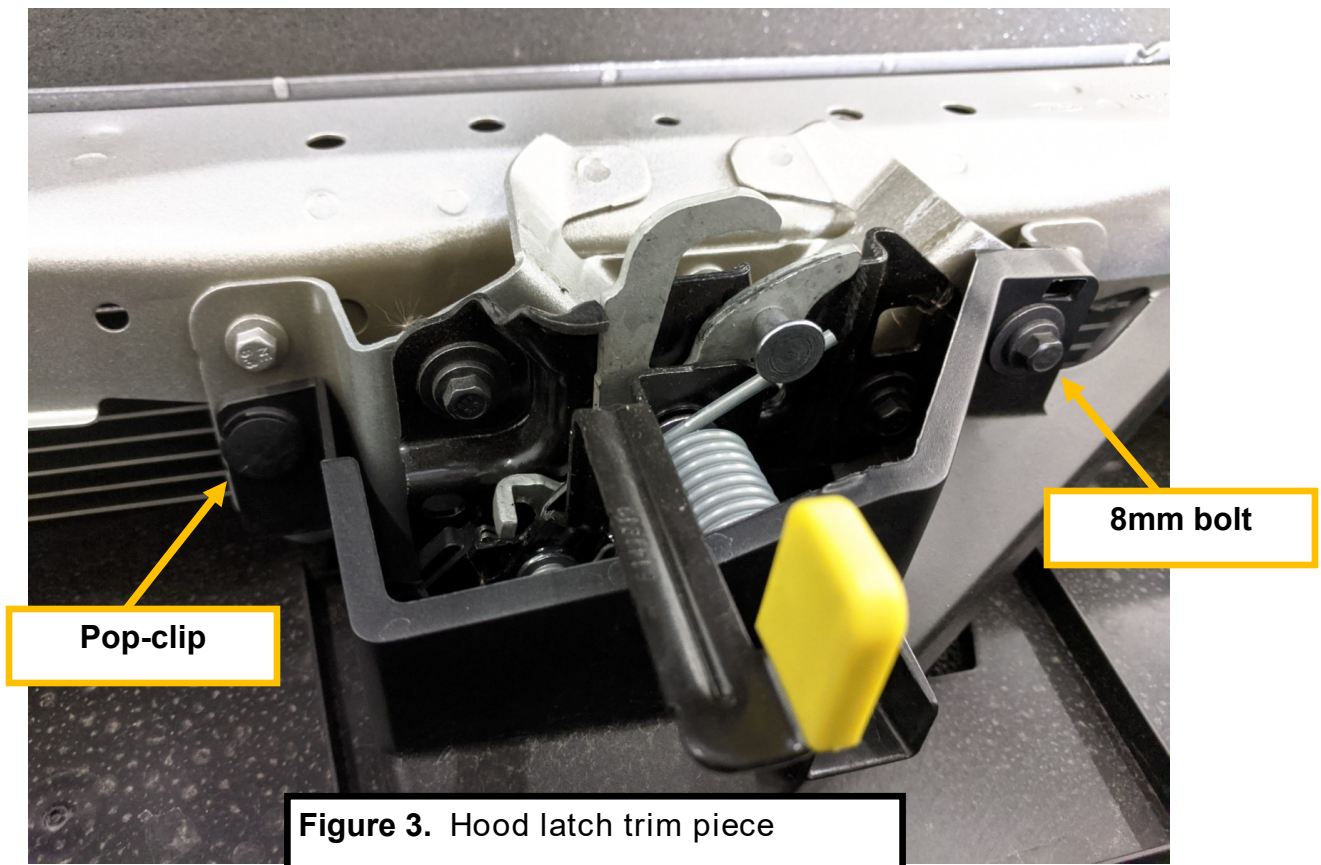

Figure 1. Radiator shroud fasteners.

3. Pull up on radiator shroud to remove.
4. Remove 2x 10mm bolts on top of grille (**Figure 2**).



5. Remove pop-clip and 8mm on plastic trim piece covering hood latch (**Figure 3**).



6. Gently pry grille mounting tabs over locating pin to loosen grille (**Figure 4**).
7. Remove 4x T25 bolts securing plastic shroud behind grille. Remove shroud (**Figure 5**).

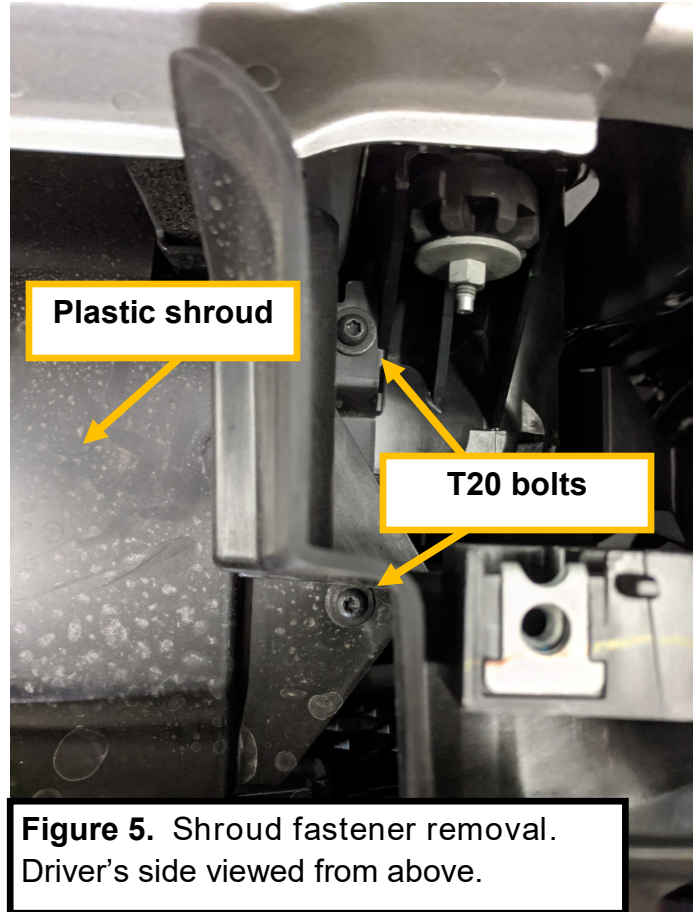
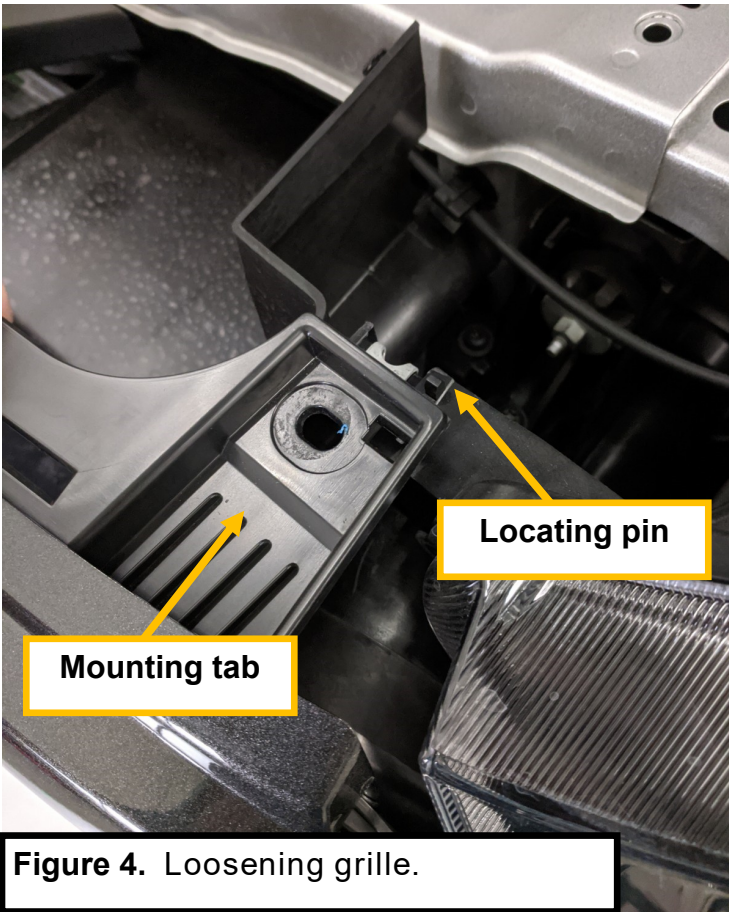

8. Using a flat head screwdriver, depress clips securing grille to bumper (**Figure 6 & 7**). There are 5 clips on the bottom and 1 on each side of grille. It may be easier to use a short/stubby flat head screw driver on the bottom clips.

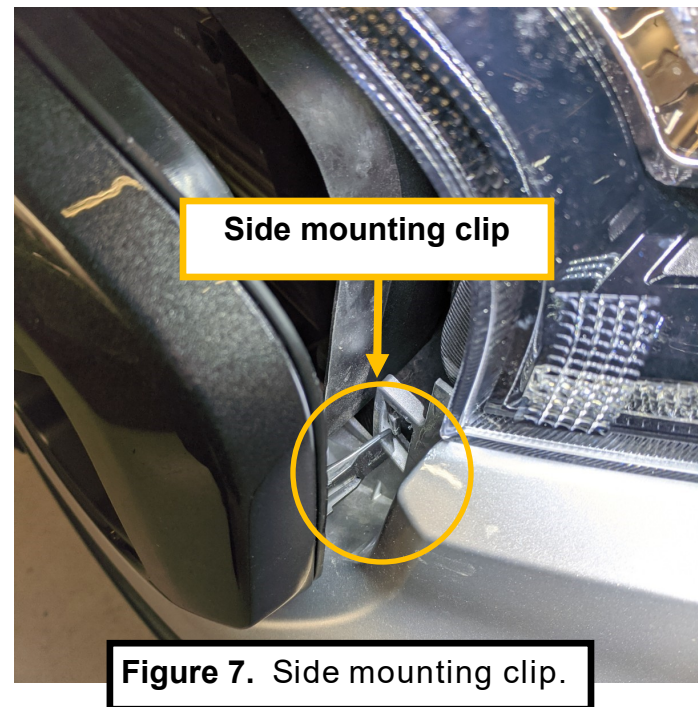
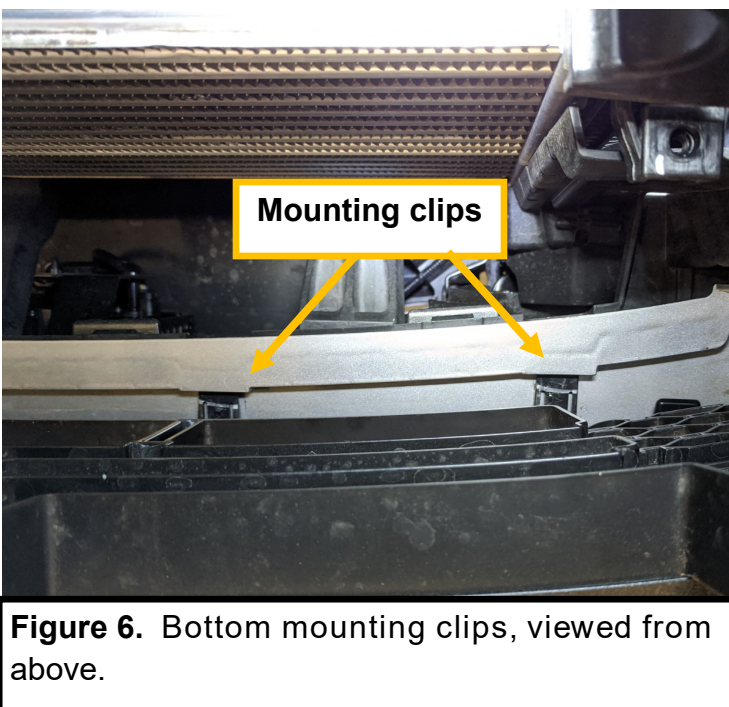

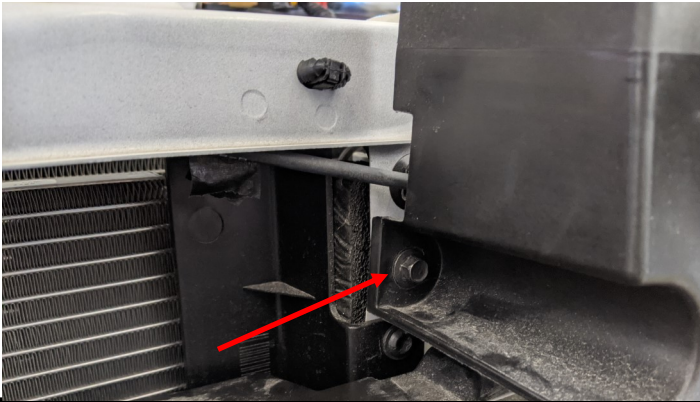

Figure 8. Radiator shroud bolts.



Figure 9. Bracket mounting orientation.

9. Remove grille and set face down, being careful not to scratch the front of the grille.
10. Using the 8mm socket, remove bolts securing the radiator shroud to the radiator support (**Figure 8**).
11. Install the brackets onto the light bar as shown in **Figure 9** using the 5/32" Allen.
12. Using **Figure 10** as a guide for hardware order, reinstall the radiator shroud and the light bar and bracket assembly with the included washers.
13. Reinstall the grille and refer to the instructions included with the light bar for wiring instructions

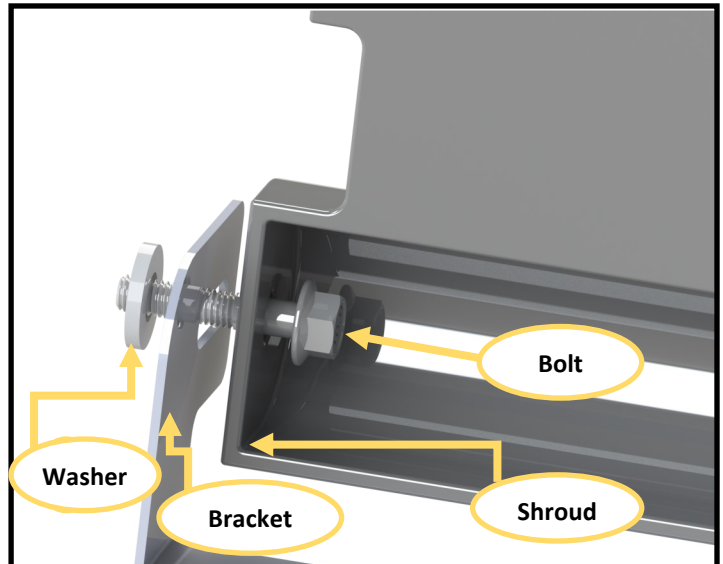

Figure 10. Bracket hardware orientation.



Your Putco light bar is now installed. Refer to the instructions included with light bar for wiring instructions. (This kit is designed for Putco 10020/11020 LED 20" light bar)