

# INSTALLATION INSTRUCTIONS

**WARNING: NEVER EXCEED YOUR VEHICLE MANUFACTURER'S RECOMMENDED TOWING CAPACITY**

## STRAIGHT TONGUE POSI-LOCK COUPLER REPAIR KIT - CLASS 2



### PARTS LIST

Item#	Qty	Description
1	1	Handle ASM
2	1	Release spring
3	1	Underjaw
4	1	Square washer
5	1	Tension spring
6	1	Locknut, 1/2"

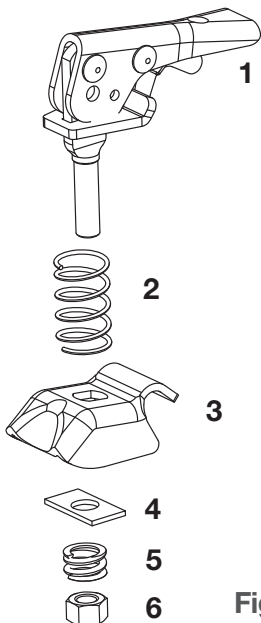

Figure 1

## WARNINGS

For 2" trailer balls

**Capacity:** 3,500 lbs.

**Tongue weight:** 500lbs.

Read instructions carefully before installation or operation. Failure to follow these warnings and installation instructions will result in separation of tow vehicle and trailer, which can result in death, personal injury and property damage.

Always note proper installation of underjaw; notch in underjaw should engage coupler body cross shaft at all times. Failure to do so could result in coupler failure.

## INSTALLATION

### Step 1

Place the handle in the locked position with a trailer ball in the coupler. Insert the handle (#1) through the latch hole in the coupler. Place the release spring (#2) on the handle, on the underside of the coupler.

### Step 2

Attach the underjaw (#3) to the handle and release spring. See figure 2. **Note:** The notch in underjaw should engage the coupler body cross shaft. See figure 3.

### Step 3

Tighten locknut (#6) against the square washer (#4) and tension spring (#5) underneath the underjaw so that the coupler is not loose on the ball. See figure 2. Correct adjustment will allow handle to be released with moderate pressure applied to the release latch.

### Step 4

After towing 50 miles, check the tightness of the coupler on the ball. Be sure latch handle is in the locked position.

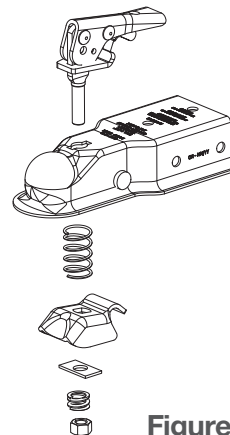

Figure 2

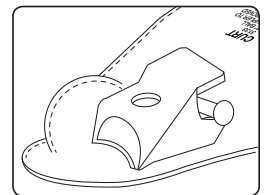

Figure 3