

INSTALLATION INSTRUCTIONS AND PARTS LIST

MODEL 410078/410088

BLACK ALUMINUM BACK SPLASH FOR GRIP STEP:

1. Read instructions completely and check to make sure that all required parts (listed on service parts list) are on hand before starting the installation.
2. This product is a universal product designed to fit the 78" and 88" Grip Step boards. It may need to be cut to fit shorter applications, or pieced together to fit longer applications:
 - 2.1. Measure the distance between the end caps of the step board that this needs to fit.
 - 2.2. Using a chop saw or tin snips, cut the backsplash approx 1/2" shorter than the measured length.
 - 2.3. It may be necessary to cut the angle on the ends of the backsplash to clear the vehicle..
3. Attach the backsplash to the Step.
 - 3.1. Line up the backsplash to the back of the grip step as shown on the instructions.
 - 3.2. Using the supplied self drilling screws (item #2) attach the backsplash to the back of the step.
 - 3.3. You may choose to attach the step to the bracket before attaching the backsplash to the back of the step
4. Attach the step to the brackets as shown in the instructions for the bracket package.

SERVICE PARTS LIST

ITEM	PART NO.	QTY	DESCRIPTION
1	552401	2	BACK SPLASH,ALUM,BLACK GRIP STEP, 410078
1	552402	2	BACK SPLASH,ALUM,BLACK GRIP STEP, 410088
2	107958	10	SCREW-SELFDRILLING, #8 X 1/2", SST,BLK



SERVICE PARTS LIST

MODEL NO. - 410078
410088

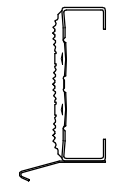
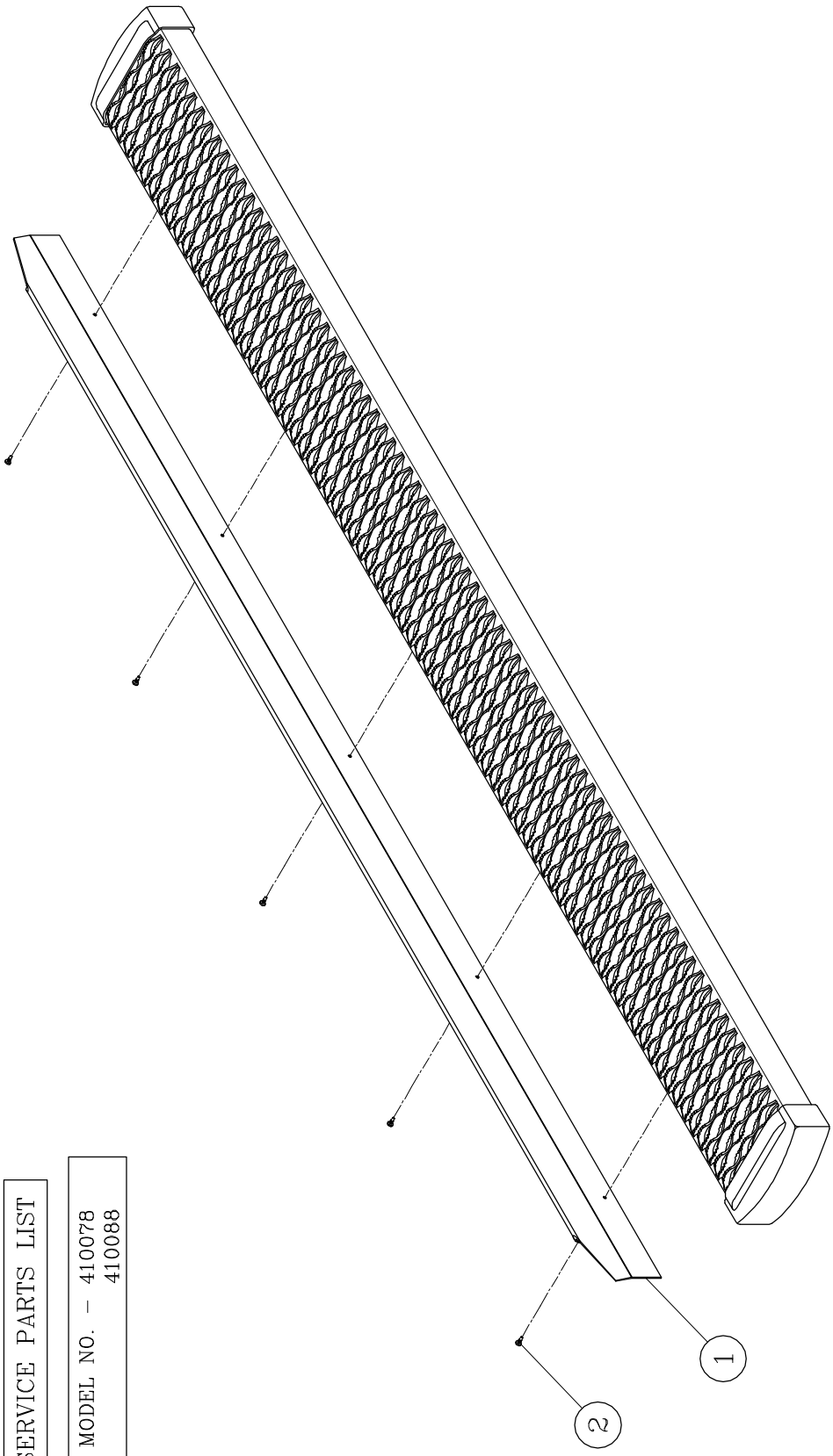

FORD F150
TOYOTA TUNDRA

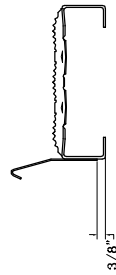

SILVERADO/GMC

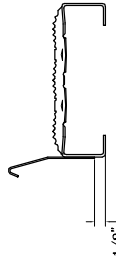

DODGE RAM

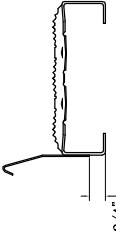

FORD SUPER DUTY



1200 E. BRUSH ST.
BRYAN, SD 57005

APPROXIMATE TOE PLATE LOCATIONS