

INSTALLATION MANUAL

481443

Level of Difficulty

Easy

This is the second of two manuals required to complete this installation. The first manual is included with your mounting brackets.

Parts List

Item	Qty	Description
1	8	Carriage bolt, #10
2	12	Neoprene flat washer, #10
3	4	Carriage bolt (clipped), #10
4	12	Serrated flange nut, #10
5	2	Spacer plate
6	1	Driver / left side step
6	1	Passenger / right side step

Tools Required

Ratchet	Torque wrench
Socket set	Level
Socket extension	--

Torque Specifications

#10 bolt	22 in-lbs.
Use above torque setting unless otherwise noted	

Product Photo



NOTICE

Before you begin installation, read all instructions thoroughly.

Proper tools will improve the quality of installation and reduce the time required.

To help prevent damage to the product or vehicle, refer to the specified torque specifications when securing hardware during the installation process.

Maintenance

To protect the product, wax after installing. Regular waxing is recommended to add a protective layer over the finish. Do not use any type of polish or wax that may contain abrasives that could damage the finish.

For polished, gloss and other smooth finishes, polish may be used to clear small scratches and scuffs on the finish.

Mild automotive detergent may be used to clean the product. Do not use dish detergent, abrasive cleaners, abrasive pads, wire brushes or other similar products that may damage the finish.

Product Registration and Warranty

CURT Group stands behind our products with industry-leading warranties.

Provide feedback and help us to improve our products by registering your purchase at: warranty.curtgroup.com/surveys

Parts List

Item	Qty	Description
1	8	Carriage bolt, #10
2	12	Neoprene flat washer, #10
3	4	Carriage bolt (clipped), #10
4	12	Serrated flange nut, #10
5	2	Spacer plate
6	1	Driver / left side step
6	1	Passenger / right side step

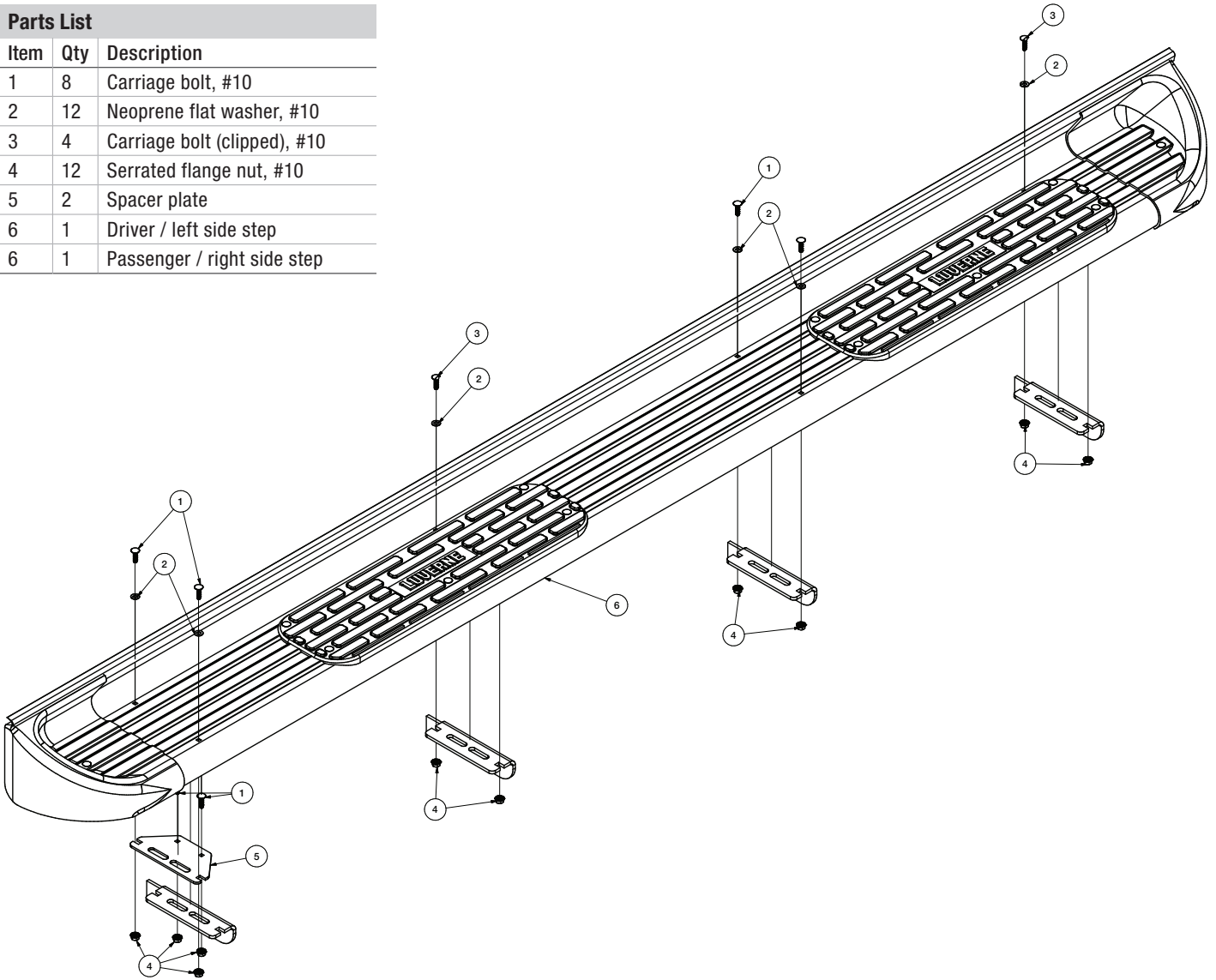

Step 1

With the side step brackets secured to the vehicle on the passenger side, secure a spacer plate (#4) to each rear bracket using two #10 carriage bolts (#1) and nuts (#3).

Step 2

Place the side step (#5) on the brackets and align the mounting holes. Ensure that the two pre-installed carriage bolts are through the outer slots of the brackets.

Note: The passenger side board will be the board without the stickers towards the front)

Step 3

Insert four #10 carriage bolts and two clipped #10 carriage bolts (#1 and #3) into black neoprene washers (#2).

Step 4

Secure the board to the brackets using the six inserted carriage bolts, two pre-installed carriage bolts and eight serrated flange nuts (#4). The two clipped carriage bolts will go behind the step pads.

Snug the hardware, but do not fully tighten.

Step 5

Adjust and align the step with the cab. Tighten all hardware to the torque specifications listed on page one.

Repeat for the driver side of the vehicle.

Step 6

Congratulations on the installation of your new LUVERNE side entry steps.

With the side steps installed, periodic inspections should be performed to ensure all mounting hardware remains tight.

To protect your investment, see the 'Notes and Maintenance' section on page one.