

TITAN pt. no.: 02 0000 0239

Important: Please read these instructions carefully and completely before starting the installation.

TITAN Fuel Tanks™
INSTALLATION INSTRUCTIONS

Gen6



Extended Capacity Replacement Tank for FORD F-150 Pickup Trucks with Power Stroke Diesel Engines, Crew Cabs, and 5.5 ft. Beds

7021518 For 2018+ FORD truck model F-150: Crew Cab, Short- Bed (5 ½ ft.)

For patent information: <http://titanfueltanks.com/patents>

No drilling or cutting is required for this installation.

Required Tools:

- 1 ea. Ratcheting socket driver
- 1 ea. 8 mm, 13 mm, and 15 mm sockets
- 1 ea. 12 inch long socket driver extension
- 1 ea. 8 mm, 15 mm end wrenches
- 1 ea. Small flat blade screw driver
- 1 ea. Large flat blade screwdriver
- 1 ea. Center Punch
- 1 ea. 2 lb. Hammer
- 1 ea. Rubber Mallet

Recommended Optional Tools:

- 1 ea. Hydraulic transmission jack
- 1 ea. Impact wrench
- 1 ea. Vehicle Lift
- 1 ea. TITAN Fuel Caddy™ to transfer fuel.

Generation 6

Tank Body Identification:



Note: The tank body has the above identification on its bottom. Please check to be sure the tank is properly identified as the one to fit your vehicle.

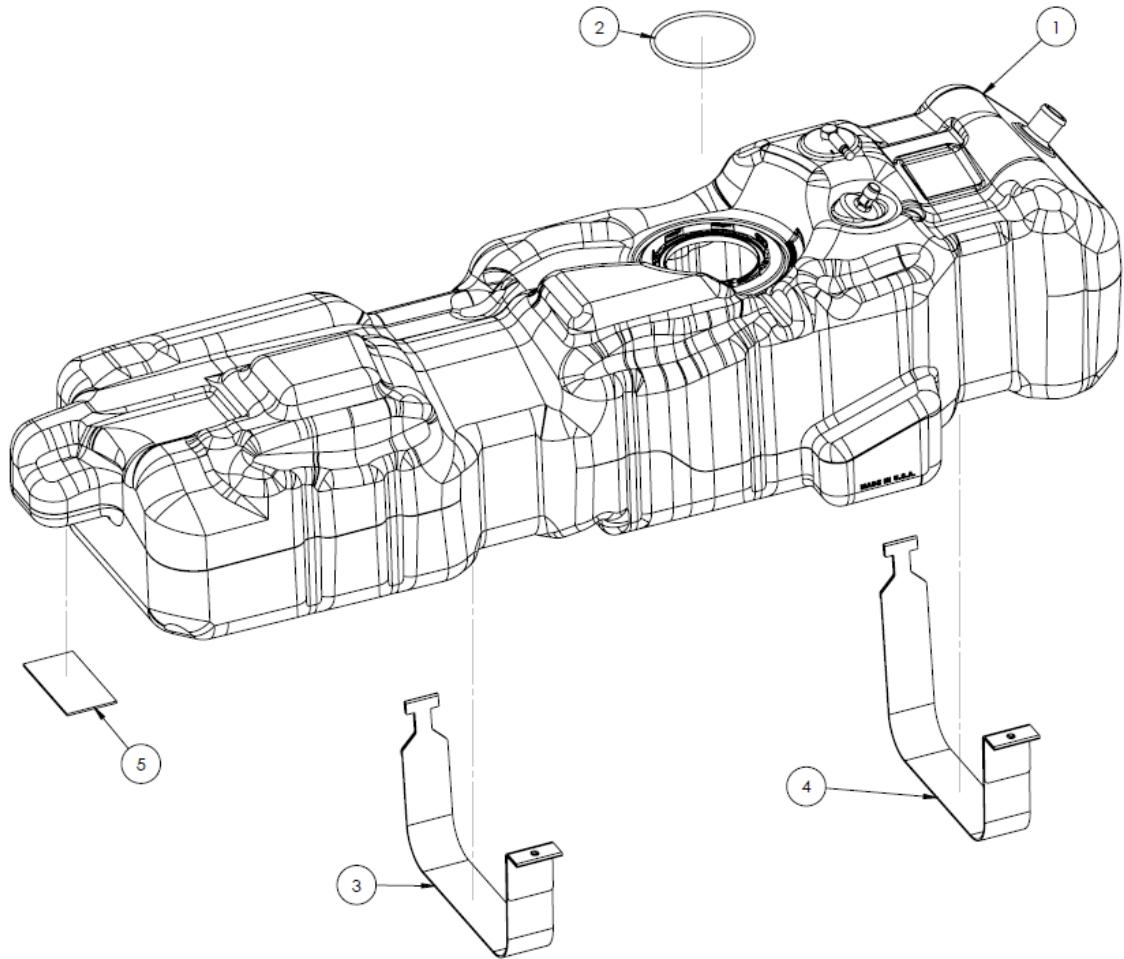

7021518 PARTS LIST

7021518

Item No.	Description	TITAN Part Number	Quantity
1	2018 Ford F-150 Titan Tank Assembly	02 0000 0216	1
2	Orange O-Ring	02 0000 0197	1
3	2018 Ford F-150 Front Strap	02 0146 0000F	1
4	2018 Ford F-150 Rear Strap	02 0146 0000R	1
5	EPDM Rubber Pad	01 0000 0147	1

IMPORTANT NOTICE: Before installation, be sure to thoroughly inspect inside of the tank for ANY foreign debris!

NOTE: Take a moment and write the new TITAN™ Tank serial number in the back of this instruction booklet now. The serial number is found on the bottom of tank.

NOTE: If this tank is to be installed on the ground without a lift, please be aware that the front of the tank must be installed first to rest on a frame cross-member and requires the tank to be lifted in at an angle. Thus, the installer will have to be able to raise the vehicle high enough to obtain clearance for the tank to be at an angle (See Step 18 and Fig. 11).

I. Remove Original Equipment Tank

Step	Description
1	Using best, safe practices, place the vehicle on a hoist that leaves the entire underside of the frame unobstructed.
2	Drain all the fuel from the original equipment (OEM) tank using a TITAN Fuel Caddy™, or a pump, or siphon.
3	Remove any shield which may be in the way of removing the tank (See Fig. 1).
4	Disconnect the fill hose and vent hose from the OEM tank.
5	Next, disconnect the fuel lines at the front of the tank (See Figs. 2 & 3).
6	Support the OEM tank.
7	Loosen and remove OEM tank straps by undoing the bolts on the outboard side of the tank and unhooking on the inboard side (See Fig. 4). Hold the factory “J-nuts” with an end wrench to prevent them from breaking. Lower the tank a few inches.
8	Disconnect fuel gauge electrical connection from sending unit on top of the tank.
9	Remove the OEM tank from the vehicle.



(Fig. 1) Remove OEM shield.



(Fig. 2) Disconnect the fuel lines at front of the tank.



(Fig. 3): **Method for Disconnecting Fuel Line Couplings:** The couplings involved in this installation are of the quick connect type shown in left photo above. To disconnect, a) Slide the tab that has teeth on its edge outwards as shown in the center photo. b) Next, press the rounded button, as shown in the right photo, and pull the coupling apart.

II. Prepare Vehicle and Replacement Tank

Step	Description
------	-------------

- | | |
|----|---|
| 10 | Disconnect all of the fuel lines from the sending unit. |
| 11 | Loosen the OEM hold-down ring on the sending unit by turning it counter-clockwise (See Fig. 5). |
| 12 | Remove the sending unit from the OEM tank (See Fig. 6). |

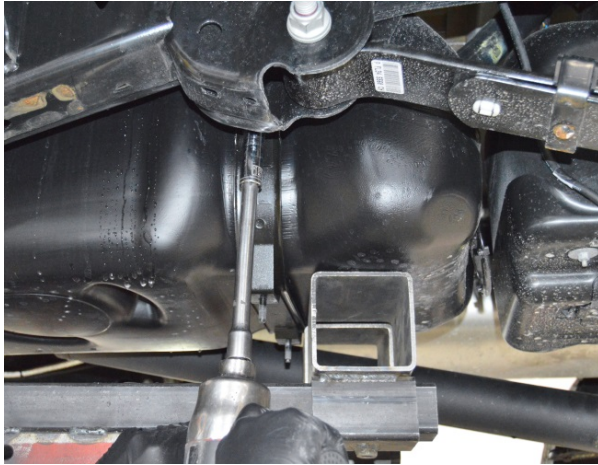

(Fig. 4) Remove OEM straps.



(Fig. 5) Loosen the OEM hold-down ring by turning it counter-clockwise.



(Fig. 6) Remove the sending unit.



(Fig. 7) Line the tab on the sending unit up with the tab location marks on the TITAN tank.

Step	Description
------	-------------

- | | |
|----|---|
| 13 | The new TITAN tank comes with an orange O-ring to seal the sending unit. Make sure the new O-ring gasket is placed into the gland (groove) at the sending unit opening. |
| 14 | Place the sending unit into the TITAN tank on top of the orange O-ring. Be sure to turn the sending unit so that the tab lines up with the "tab location" marks on the tank (See Fig. 7). |

- 15 Place the hold down ring from the OEM tank onto the sending unit and tighten it clockwise as far as it will go (See Fig 9).
- 16 Install the fuel lines on the sending unit as they were on the OEM tank (See Fig. 10).

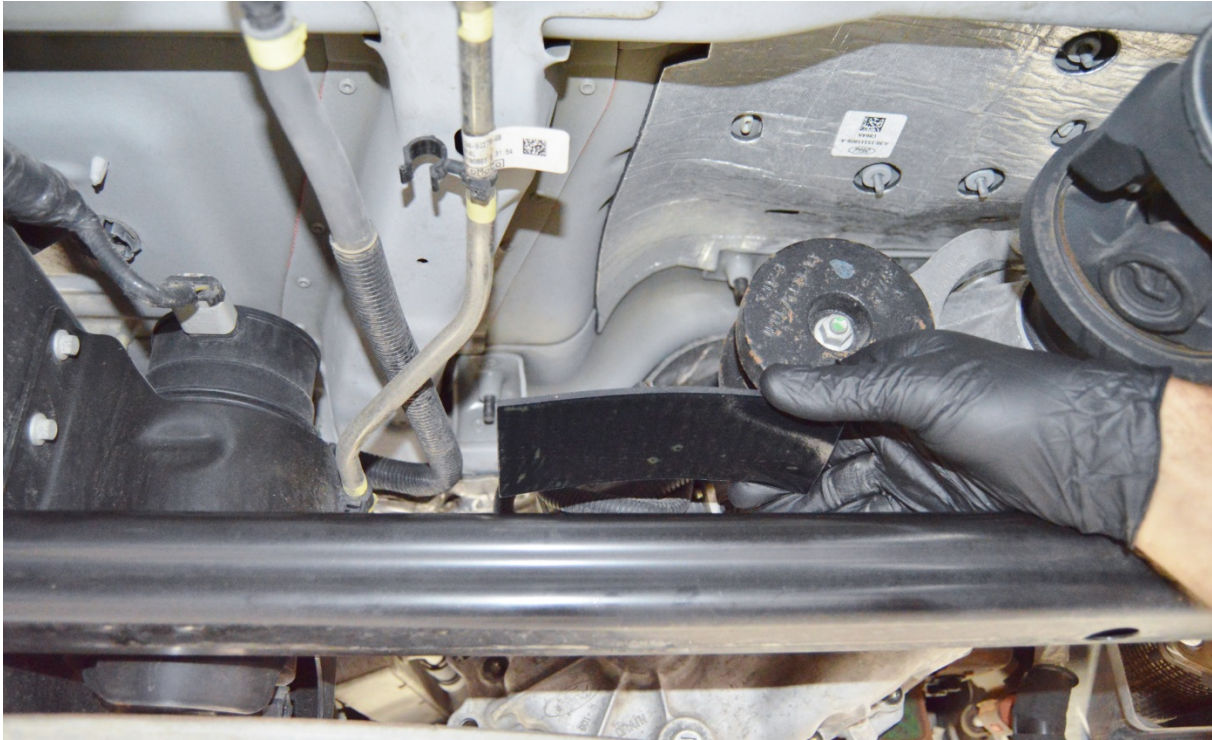

(Fig. 8) Place the EPDM Rubber Pad (pn. 01 0000 0147) on the top of the cross member, adhesive side against the cross member, being sure to center it under the tank's front protrusion.



(Fig. 9) Use the OEM hold-down ring and tighten it by turning it clockwise as far as it will go.



(Fig. 10) Fuel lines installed on the new TITAN tank.



(Fig. 11) Angle tank slightly as it is lifted in so that front protrusion on tank slides over cross-member.



(Fig. 12) Connect fuel line couplings at the front of the tank before it is lifted all the way into place.



(Fig. 13) To install the new straps, turn and hook on inboard side of the tank, then rotate. Then tighten bolts on the outboard side.

Step	Description
------	-------------

- | | |
|----|--|
| 17 | The front of the new TITAN tank has a support protrusion which is meant to rest on the cross member which is between the tank and the transmission. Place the EPDM Rubber Pad (pn. 01 0000 0147) on the top of the cross member, adhesive side against the cross member, being sure to center it under the tank's front protrusion (See Fig. 8). Clean the top of the cross member to insure adhesion. |
|----|--|

III. Install Replacement Tank in Vehicle

Step	Description
18	Support the TITAN tank and lift it nearly into place leaving enough space to be able to reach up and plug the fuel gauge electrical connection onto the sending unit. Angle the tank as you lift it into place so that the front support protrusion slides over the cross member at the front of the tank (See Fig. 11).
19	Reconnect the fuel line connections which were on the front of the OEM tank (See Fig. 12).
20	After plugging in the electrical connection on the sending unit, and connecting the front fuel line connections, lift the tank all the way into place.
21	Install the front and rear straps provided with the new TITAN tank. The straps may have to be turned to hook on the inboard side, and then rotated into place (See Fig. 13). Install the straps finger tight.
22	Connect the fill hose and vent hose to the tank.
23	Now tighten the straps to the vehicle manufacturer's specifications.
24	Make sure ALL mounting hardware, clamps, bolts, etc. are properly installed and TIGHT. Double check it.
25	<u>IMPORTANT! Lower vehicle, fill tank with diesel fuel to the first nozzle "click-off" and check for leaks.</u>

Go to TITAN's website for more information and installation tips.

* All capacities are approximate

Be sure to return the completed warranty registration for your new Titan fuel tank; or you can register on-line at www.titanfueltanks.com

You will find your tank's serial number located on the bottom of the tank.

Write your tank's Serial Number here: _____

A tank must be registered within sixty (60) days of receipt for the warranty to be valid.

Warranty is void if product is improperly installed.

For questions or customer service call **(800) 728-4982**



TITAN Fuel Tanks
P.O. Box 2225
Idaho Falls, ID 83403 USA
Telephone (208) 522-1325, FAX (208) 529-2162
www.titanfueltanks.com
TITAN Fuel Tanks are PROUDLY MADE IN THE USA
Revised 8.14.19 ©2019 Supertanks, LLC. All rights reserved.