



## Installation Instructions

Front and Rear Bolt-On/Rugged Look Fender Flare  
Ford Ranger 19-on - FF942

**Important: Please read instructions entirely before installing this product.**

Hardware Included	QTY
EXTRUSION	27ft
LARGE U CLIP (Marked X)	12
SMALL U CLIP	2
SCREWS	6

Hardware Included	QTY
ALCOHOL TOWELETTE	4
SCREW PLUG	6
WASHERS	6
TAPE SQUARES	6

Bolt Kit only	QTY
NUTS	35
TORX BOLT DRIVE	35

Ensure that both left and right hand Fender Flares suit the profile of the vehicle. Note the areas where the Fender Flares come in contact with the vehicle. NOTE: Before fitting Fender Flares remove any moldings, strips or existing flares from the wheel arch. If there is a body side molding, mark where the molding is to be cut, alternatively the Fender Flare can be cut to go around the molding. Be sure to allow enough room for the extrusion. **No drilling of vehicle is required for Bolt-On Look Fender Flares. This is a non-drill product.**

**\*PRIOR TO ANY PAINTING & INSTALLATION, PRODUCT SHOULD BE THOROUGHLY INSPECTED FOR ALL COMPONENTS LISTED ABOVE. PRODUCT SHOULD ALSO BE TEST FITTED PRIOR TO ANY PAINTING & INSTALLATION. PLEASE CONTACT EGR IF YOU HAVE ANY FITMENT QUESTIONS AND OR MISSING COMPONENTS.**

**FOR RUGGED FLARES, INSTALL WILL START AT STEP 2**

**IF FLARES ARE PURCHASED PAINTED, INSTALL WILL START AT STEP 4**

**PAINTING INSTRUCTIONS** – If Fender Flares are being painted; do not install edge extrusion until painting is complete. Prior to painting, clean all surfaces to be painted using clean water and a mild detergent, do not use lacquer thinner or any solvent based products. Wipe completely dry. Best results will be achieved by wiping the areas to be painted with a tack rag just prior to painting. Most automotive paints can be applied directly to the Fender Flares, however some may require a primer (check paint manufacturer specifications). Good adhesion will be achieved without sanding. Select a paint (and primer if necessary) that is suitable for rigid plastics PMMA (Acrylic). If using a paint system that requires baking, do not expose the product to temperatures above 70°C (158°F). Do not fit the extrusion or any of the hardware to the Fender Flares until the paint is completely dry.



**STEP 1:** Attach the bolts and nuts to each Fender Flare using a 3/16" Allen key/Trox and a 1/2" wrench/socket. (wrench /socket and Allen key not supplied). Ensure inside of Fender Flares where the rubber seal is attached is clean, using the alcohol wipes provided. Wipe away any residue with a dry clean cloth.



**STEP 2:** Attach the included rubber seal to the Fender Flares. Peel back 2" of the adhesive backing and position on the Fender Flare. Attach the seal to the Fender Flare, peeling back a few inches at a time. Ensure pressure is used to secure rubber seal to Fender Flare edge. Attach rubber seal along all areas the Fender Flare will make contact with the vehicle body.

For Technical Support/Warranty Information please call 800-757-7075

EGR Inc., 4000 East Greystone Drive, Ontario, CA 91761



## Installation Instructions

Front and Rear Bolt-On/Rugged Look Fender Flare  
Ford Ranger 19-on - FF942

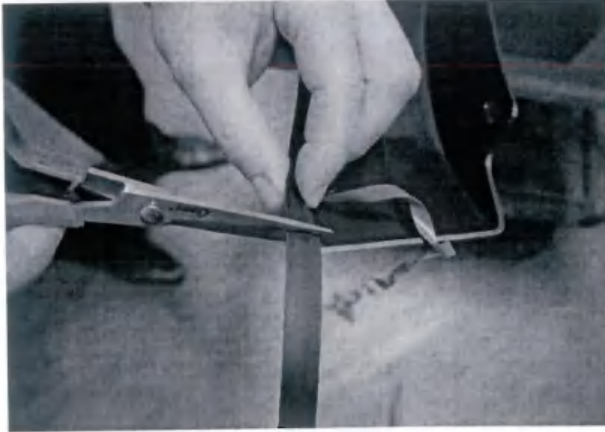

**STEP 3:** Trim excess rubber seal and discard.



**STEP 4:** Clean the body areas where the Fender Flares will make contact. Ensure fenders are dry prior to install. Turn tires outward for Fender Flare installation.

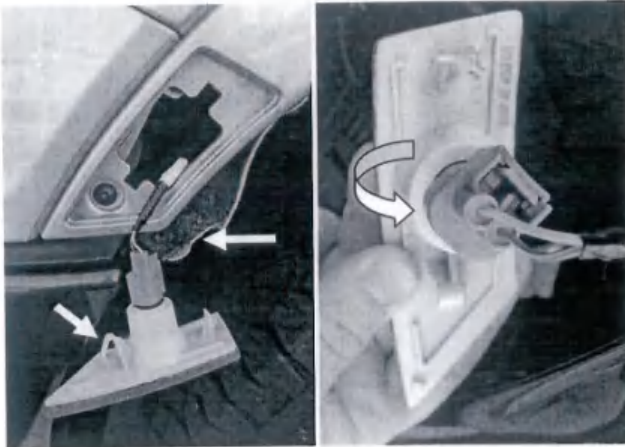

**STEP 5:** Removal of the turn signal is required for installation of front Fender Flares. Pull back the inner wheel well liner to locate the turn signal body and wiring. Remove the turn signal from the vehicle body by squeeze the lower tab on the back of the turn signal body. Carefully turn the wiring harness counter clockwise and remove the bulb-wiring harness from the turn signal body.

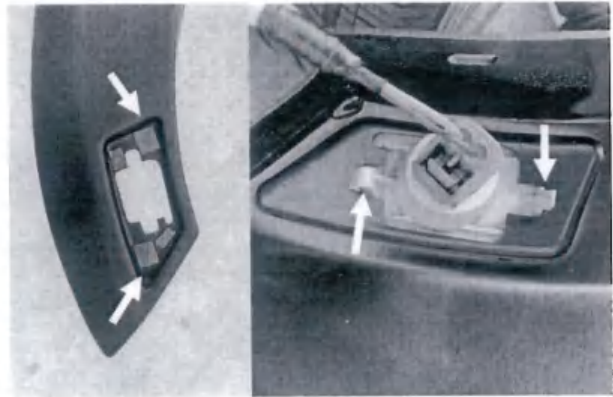

**STEP 6:** Apply the provided tape squares 3 per side to the turn signal recess, cutting of the tapes will be required per image. Remove the tape liner, install the turn signal body into the recess in the front Fender Flares. Ensure the tabs in the back of the turn signal body snap into the Fender Flare recess pocket. Apply firm pressure across the turn signal once in place to achieve tape wet out. Reinstall the bulb-wiring harness to the turn signal body.

For Technical Support/Warranty Information please call 800-757-7075

EGR Inc., 4000 East Greystone Drive, Ontario, CA 91761



## Installation Instructions

Front and Rear Bolt-On/Rugged Look Fender Flare  
Ford Ranger 19-on - FF942

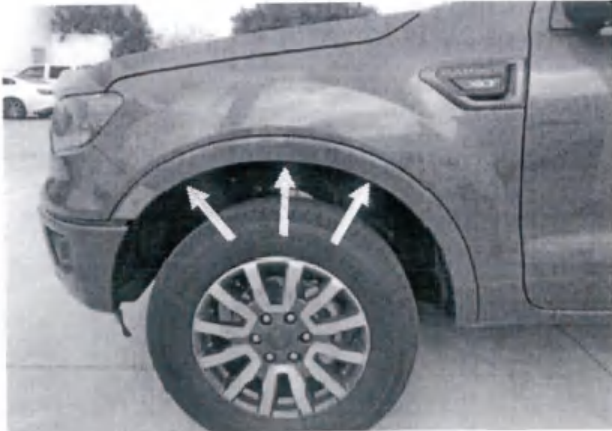

**STEP 7:** Using phillips head screwdriver remove factory wheel arch fasteners in the three shown locations. Install the screw plugs provided in the hardware kit into the shown locations.



**STEP 8:** Reconnect the bulb-wiring harness to the turn signal body, place the Fender Flare onto the vehicle into position of best fit. To secure the Fender Flare to the vehicle body, install the provided screws and washers into the screw plugs in the three shown locations.

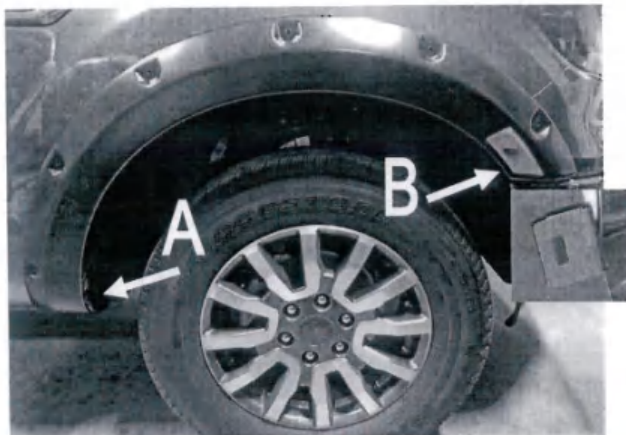

**STEP 9:** Apply upward tension on Fender Flare to the vehicle fender when installing the large U clip in location A and the small U clips in location B. Slide the clips over the Fender Flare and the inner wheel arch lip in the two locations shown. Position the clip so that the barb in the clip locates in the slot of the Fender Flare. Ensure all fixing points are tight and secure and that the rubber seal is flush neatly against the vehicle body. Repeat install steps for the opposite side.

For Technical Support/Warranty Information please call 800-757-7075

EGR Inc., 4000 East Greystone Drive, Ontario, CA 91761



## Installation Instructions

Front and Rear Bolt-On/Rugged Look Fender Flare  
Ford Ranger 19-on - FF942

### REAR FENDER FLARE INSTALLATION

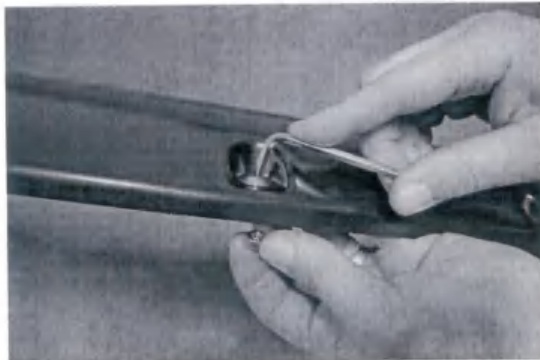

**STEP 10:** Attach the bolts and nuts to each Fender Flare using 3/16" Allen key/Trox and a 1/2" wrench/socket. (wrench /socket and Allen key not supplied). Ensure inside of Fender Flares where the rubber seal is attached is clean, using the alcohol wipes provided. Wipe away any residue with a dry clean cloth.



**STEP 11:** Attach the included rubber seal to the Fender Flares. Peel back 2" of the adhesive backing and position on the Fender Flare. Attach the seal to the Fender Flare, peeling back a few inches at a time. Ensure pressure is used to secure rubber seal to Fender Flare edge. Attach rubber seal along all areas the Fender Flare will make contact with the vehicle body. Trim excess rubber seal..



**STEP 12:** Clean the body areas where the Fender Flares will make contact. Ensure fenders are dry prior to install.

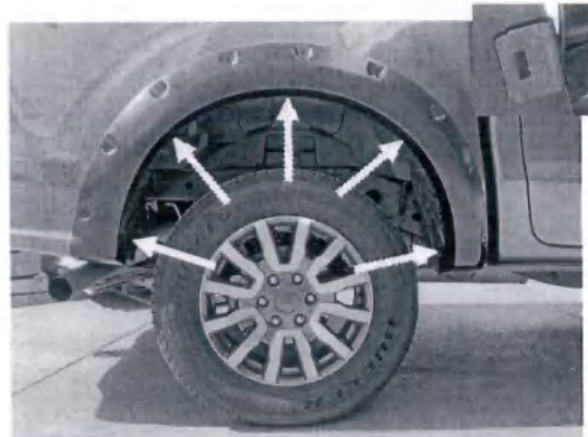

**STEP 13:** Place Fender Flare on the vehicle into the position of best fit. To secure the Fender Flare to the vehicle body, apply upward tension on Fender Flare to the vehicle fender when installing the large U clips. Slide the clips over the Fender Flare and the inner wheel arch lip in the five locations shown. Position the clip so that the barb in the clip locates in the slot of the Fender Flare. Ensure all fixing points are tight and secure and that the rubber seal is flush neatly against the vehicle body. Repeat install steps for the opposite side.

For Technical Support/Warranty Information please call 800-757-7075

EGR Inc., 4000 East Greystone Drive, Ontario, CA 91761