

IMPORTANT:

Manufacturer is not responsible for negligent use of vehicle with mud flaps installed, including over-tightening of screws and bolts causing damage to vehicle or mud flaps.

NO-DRILL SYSTEM

TOOLS REQUIRED-



Phillips Screw Driver

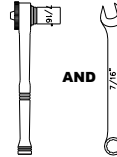

10mm Open Wrench and
Socket Wrench

FLAPS & BRACKETS

(1) Flap Assembly,
Rear, DS
Part #766434

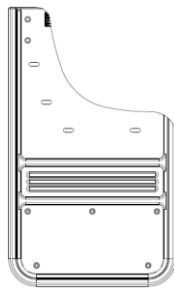

(1) Flap Assembly
Rear, PS
Part #766435

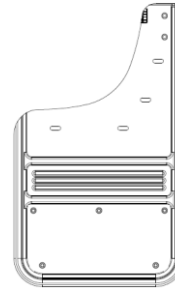

(1) Rear Brace, DS
Part #766415

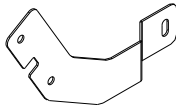

(1) Rear Brace, PS
Part #766416

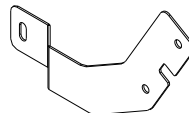

(2) Rear Washer Plate
Part #766417

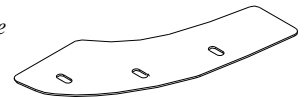

PARTS BAG # 766433

a) (6) Screw, Sht Metal
SS, #14-10 x 1-1/4"
Part #010047



b) (2) Screw, Mach.
SS, M6-35mm, Hex
Part #012028



c) (10) Washer, Flat
0.281" x 1", SS
Part #018028

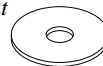

d) (2) Washer, Lock
18-8SS, 1/4"
Part #024000



e) (2) Nut, Hex
SS, M6-1
Part # 025022



f) (4) Serrated Flange Nut
Plated, M6-1
Part # 025025



g) (6) Washer, Nylon
1"OD x 0.318"ID x 0.04"
Part # 054061



INSTALLATION *(For ease of installation it is suggested that the wheel be removed)*

1. Before you install your Mud Flap Set, see the diagram and parts list for all necessary parts.
2. Remove the factory splash guard by removing the (5) factory screws attaching it to the fender. Once removed, reinstall (1) factory screw located at the bottom of the fender.
3. Locate two bolts protruding behind wheel well, and install rear brace on holes #1 and #2 and secure using (2) serrated flange nuts (#025025). See Diagram.
4. Loosely install mud flap on brace through holes #3 & #4 using (1) hex bolt (#012028), (2) stainless steel washers (#018028), (1) lock washer (#024000) and (1) hex nut (#025022). See Diagram
5. Loosely install mud flap and washer plate using (3) stainless steel screws, (3) stainless steel washers, and (3) nylon washers through holes #5 to #7. **NOTE:** Nylon washers are used to help protect the aluminum washer plate from galvanic corrosion.
6. Using a bubble level or square, ensure that the mud flap is level. Viewing the truck from the back, the outer edge of the mud flap should appear parallel to the tires
7. Carefully tighten all fasteners (do not overtighten, as this can strip the factory plastic inserts), ensuring that the mud flap remains level.
8. Repeat procedure for the passenger side.

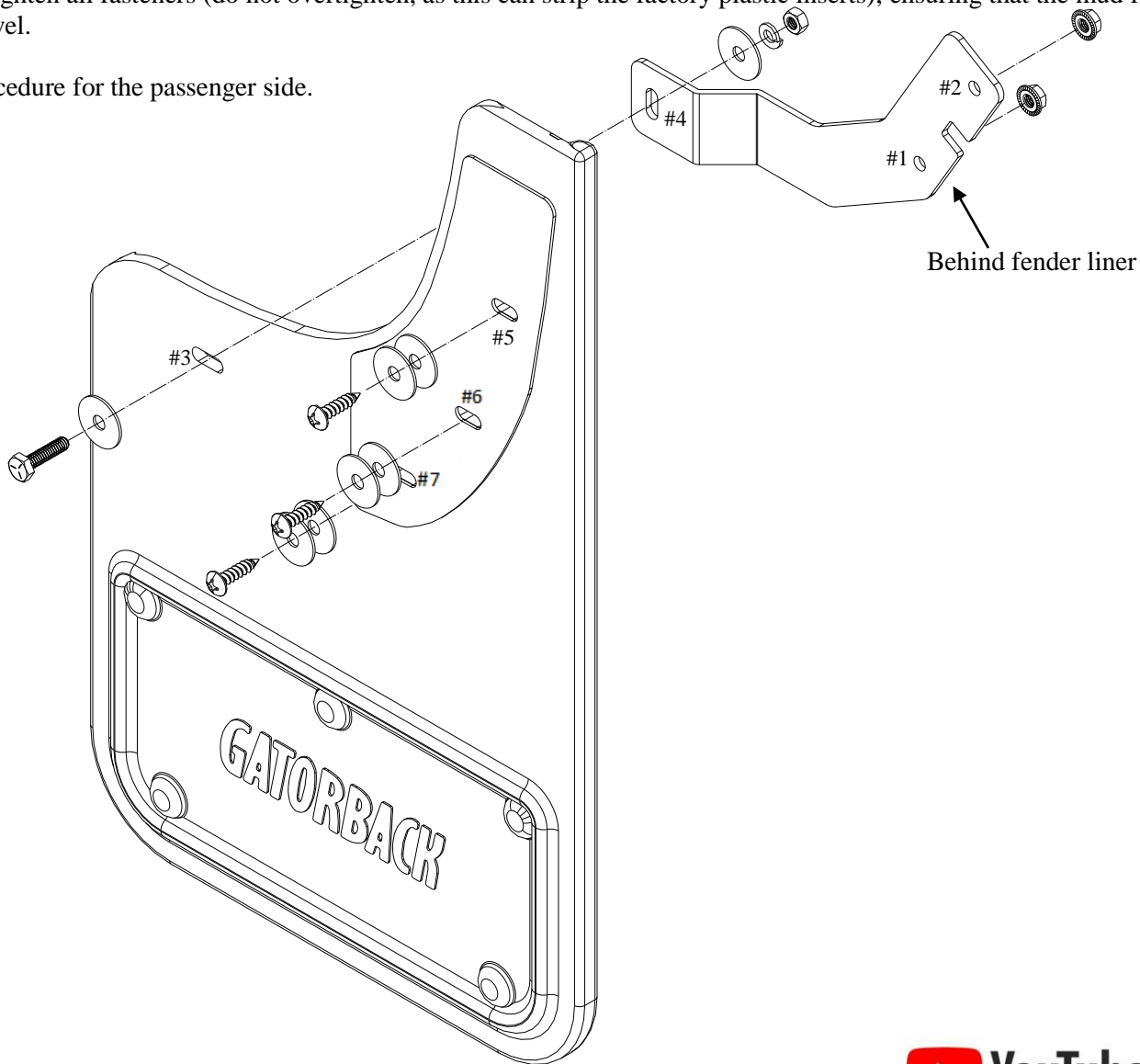

Please check out our YouTube channel to see an install video for this application.

