

Components and Hardware: HWKT-00016X

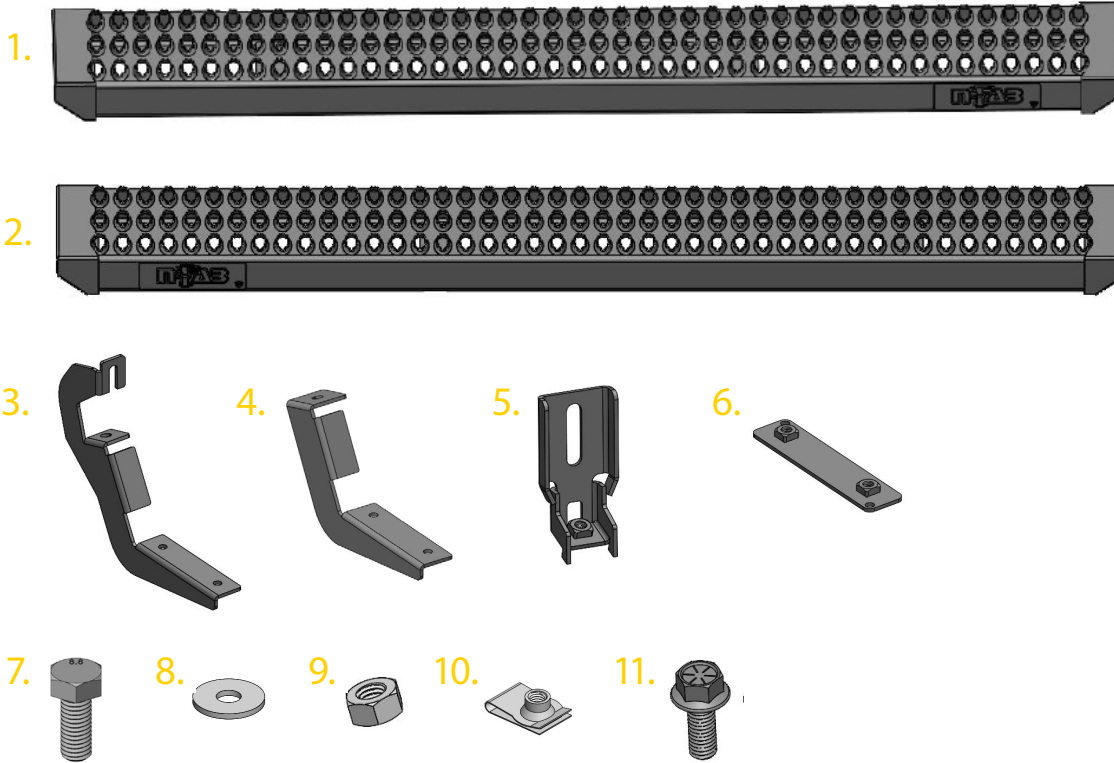

Components and Hardware:

1. Driver side board.....	(1)
2. Passenger side board.....	(1)
3. Mounting bracket.....	(3)
4. Mounting bracket.....	(1)
5. Mounting bracket.....	(1)
6. Clamp plate.....	(4)
7. M8-1.25x25mm hex bolt.....	(8)
8. M8 fender washer.....	(12)
9. M8-1.25 hex nut.....	(4)
10. M8-1.25x20mm Barrel u-clip.....	(4)
11. 3/8"-16x1" flanged hex bolt.....	(8)

Tools for Installation:

- Ratchet wrench
- 13mm socket
- 9/16" socket

INSTALL

Step 1. Look on the underside of the body and locate the factory mounting locations.

Step 2. If your vehicle is not equipped with upper threaded holes, remove the plastic body plugs and install the supplied (#10)x4 barrel u clips.



Step 3. Beginning with the driver side, install (#3)x2 mounting brackets using the supplied (#7)x4 M8x25mm hex bolt, (#8)x6 M8 fender washer and (#9)x4 M8 hex nut and loosely fasten.

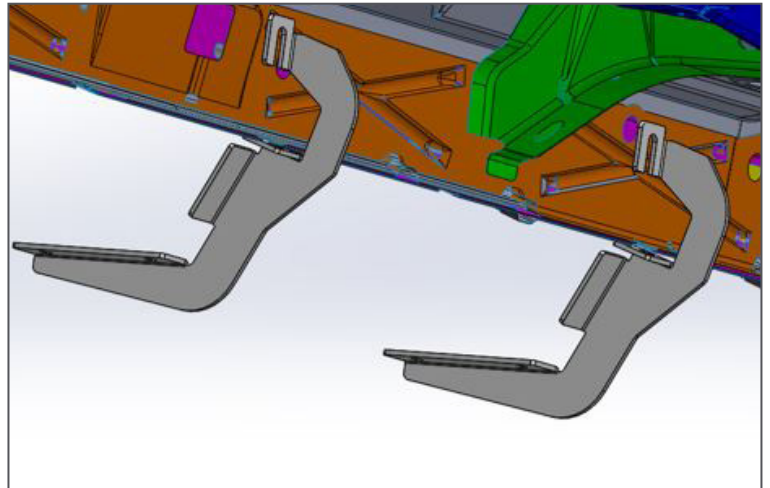

Step 4. Set running board along the top of x2 brackets and center along the cab.

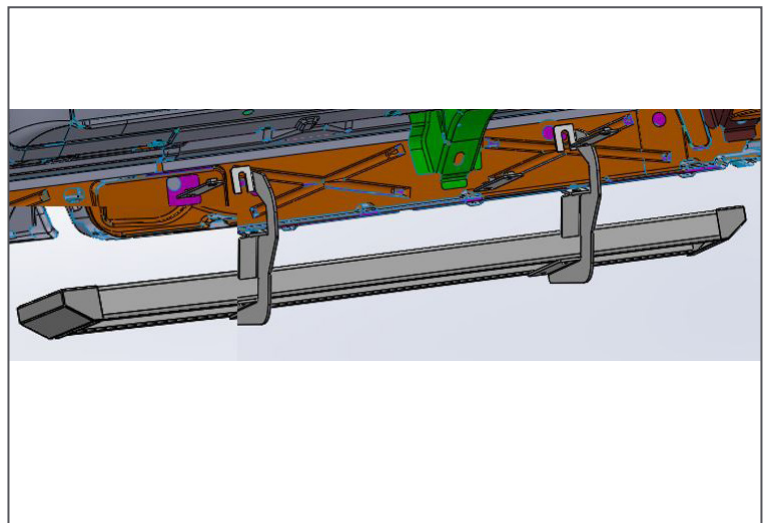

INSTALL

- Step 5.** Insert the supplied threaded clamp plate (#6)x2 inside the running board lip over the top of each bracket.
- Step 6.** With the supplied (#11)x4 3/8" x 1" hex bolts, secure each mounting location and leave loose.
- Step 7.** After final adjustment, tighten all running board threaded mounts. (35 ft/lbs)
- Step 8.** Next, adjust frame brackets so the running board is level with body of the vehicle and tighten all factory-mounting locations. (15-20 ft/lbs)

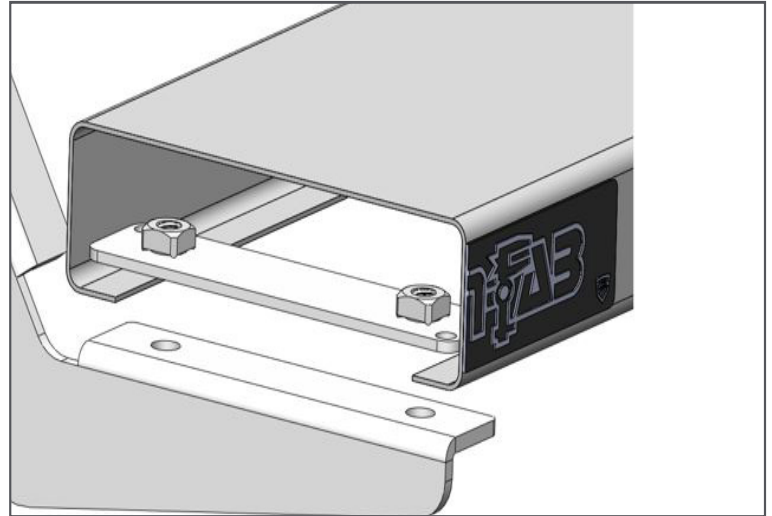

- Step 9.** For passenger side, remove the (x3) 13mm bolts, (x2) 10mm bolts and (x2) 10mm nuts that attach the Def tank cover. Remove and set aside.



- Step 10.** Feed the short bracket (#5)x1 between the body and DEF tank, then align with lower rocker panel mount.
- Step 11.** Use the supplied (#7)x4 M8x25mm hex bolt, (#8)x5 fender washer and (#9)x1 hex nut and tighten hardware to (15-20 ft/lbs).
- Step 12.** Re-install the DEF tank cover that was removed in step 9 and tighten to factory specs.
- Step 13.** Repeat steps 5-8 for passenger side running board install.

