



21-C Ford F-150

Mud Flap Set, Front

Mounting Diagram & Instructions

Part# RCR408F

IMPORTANT:

Manufacturer is not responsible for negligent use of vehicle with mud flaps installed, including over-tightening of screws and bolts causing damage to vehicle or mud flaps.

TOOLS REQUIRED:



Push Pin
Removal Tool



7/16" Open Wrench
and Socket Wrench

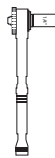

1/4" Open Wrench
or Socket Wrench



10mm Open Wrench
or Socket Wrench

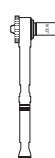

9/32" Open Wrench
or Socket Wrench

FLAPS AND BRACKETS

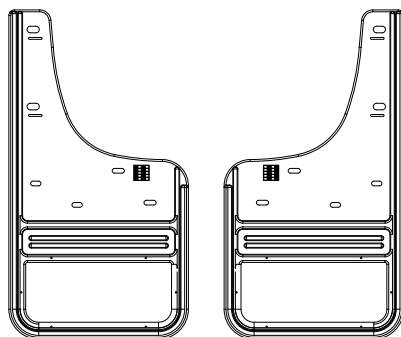

(1) Flap Front, DS

(1) Flap Front, PS

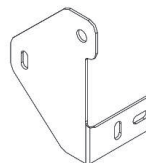

(1) Bracket Front, DS
Part #770941

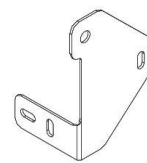

(1) Bracket Front, PS
Part #770942

PARTS BAG: #770945



a) (2) Capscrew, Blk Ox
SS, 1/4"-20 x 3/8"
Part #014069



b) (4) Cap Screw, Blk Ox
SS, 1/4"-20 x 5/8"
Part #014071



c) (2) Cap Screw, Blk Ox
SS, 1/4"-20 x 1"
Part #014073



d) (2) Cap Screw, Blk Ox
SS, 1/4"-20 x 1.5"
Part #014074



e) (4) Screw, Sht Mtl
#8-18 x 1" Blk Ox
Part #016055



f) (2) Washer, Flat
0.281" x 1", SS
Part #018068

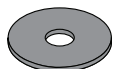

g) (4) Washer, Flat
0.281" x 1", SS, Blk Ox
Part #018069



h) (4) Washer, Flat
0.203" x 1", Blk Ox
Part #018070



i) (4) Washer, Slotted
0.281" x 1.5", SS, Blk Ox
Part #018084



j) (4) Washer, Flat
0.281" x 0.781", SS,
Part #018088



k) (6) Washer, Lock
1/4" Helicoil, SS
Part #024000



l) (4) Hex Nut
1/4"-20, SS
Part #025000



m) (2) Hex Nut
M6-1, SS
Part #025022



n) (2) Spring Nut
1/4"-20UNC, 27/32" Reach
Part #028011

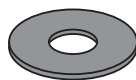

p) (2) Washer, Nylon
0.318"x1" x 0.04"
Part #054061



q) (2) Washer, Nylon
0.265" x 0.625" x .06"
Part #054071

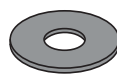

r) (4) Washer, Nylon
0.281" x 0.885" x .062"
Part #054089



s) (2) Spacer, Nylon
1/4" x 1/2" x 1/4"
Part #054099



t) (2) Mount Clip
Driver Side
Part #769308



u) (2) Mount Clip
Passenger Side
Part #769309

*(Running change - black or white)

INSTALLATION INSTRUCTIONS *(for ease of installation it is suggested that the wheel be removed)*

Note: Before you install your mudflap set, see the diagram & parts list for all necessary parts

Driver Side

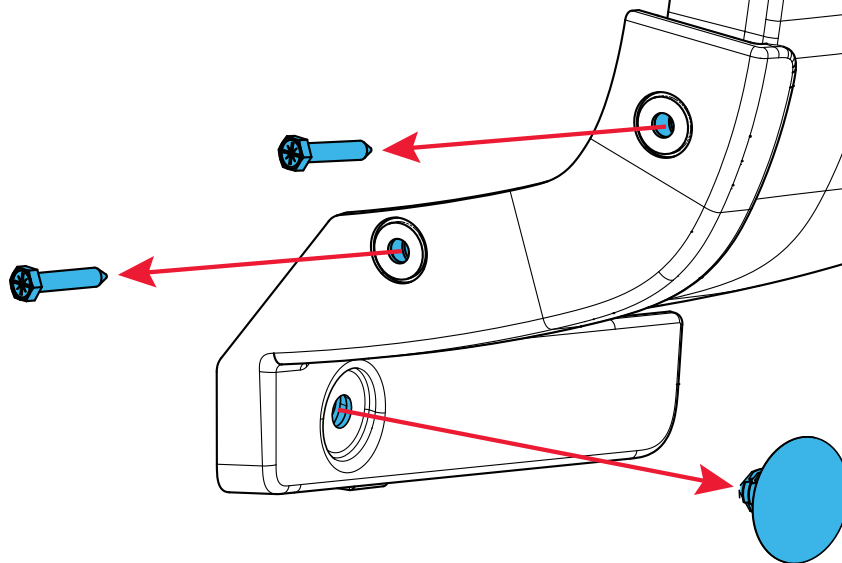

1-1 Remove factory hardware as shown

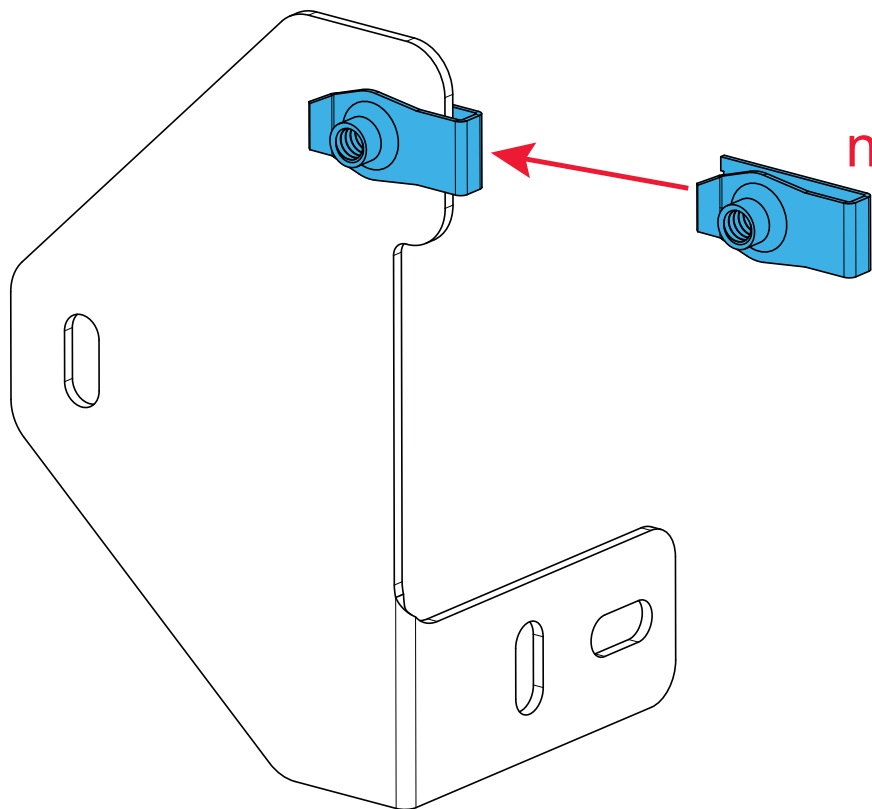

2-1 Install spring nut on bracket as shown

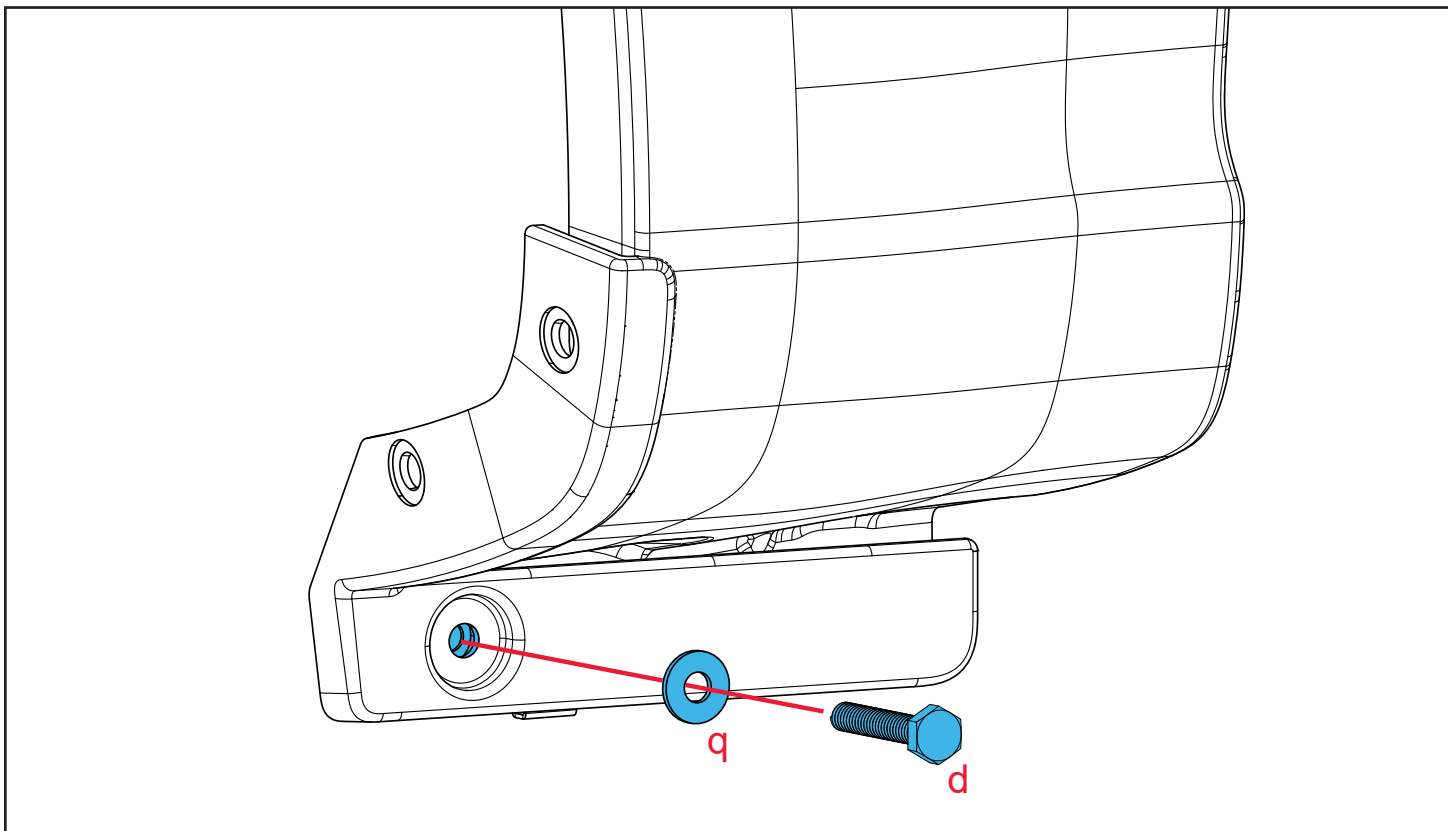

3-1 Install hardware on bracket as shown

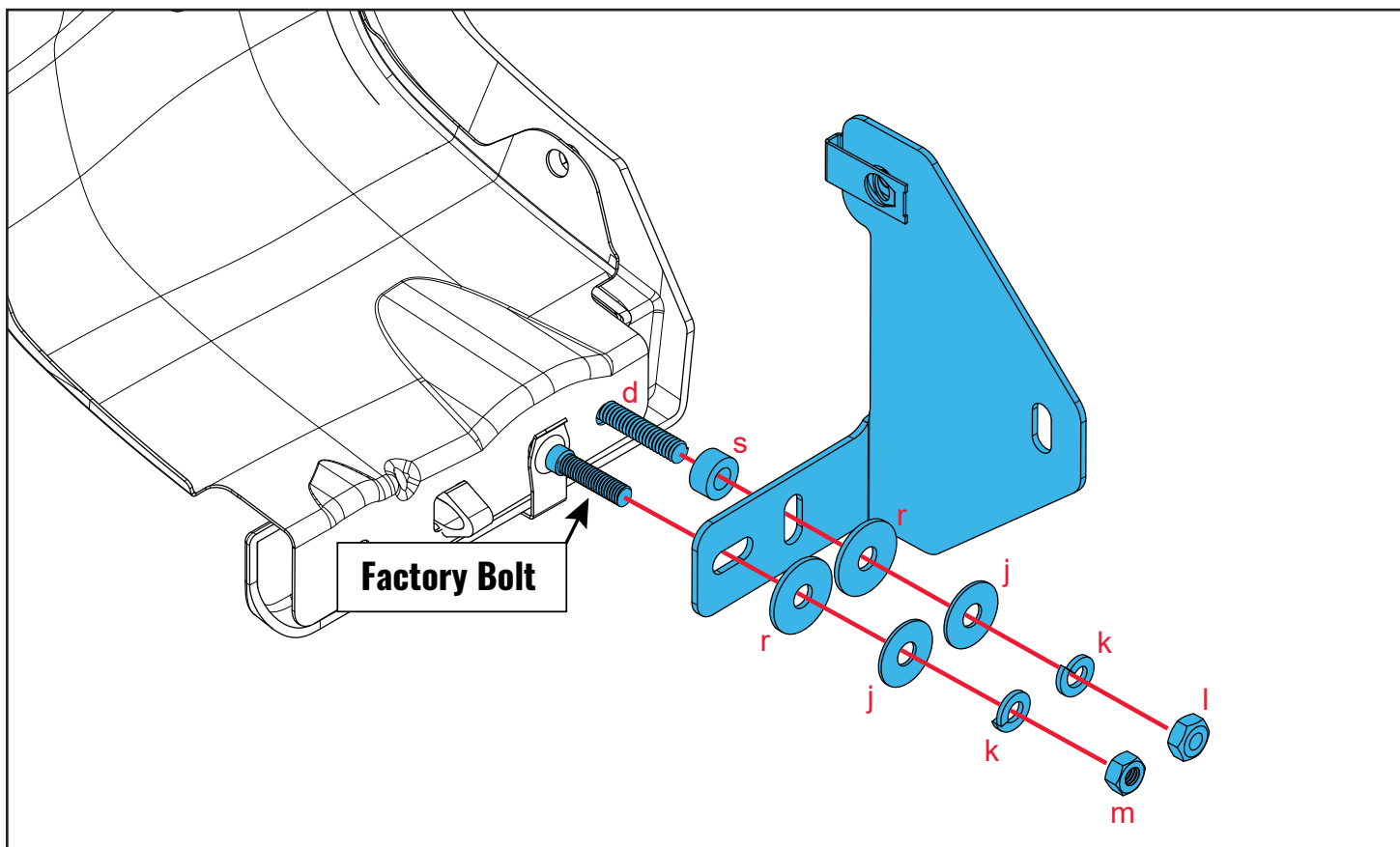

3-2 Secure bracket as shown

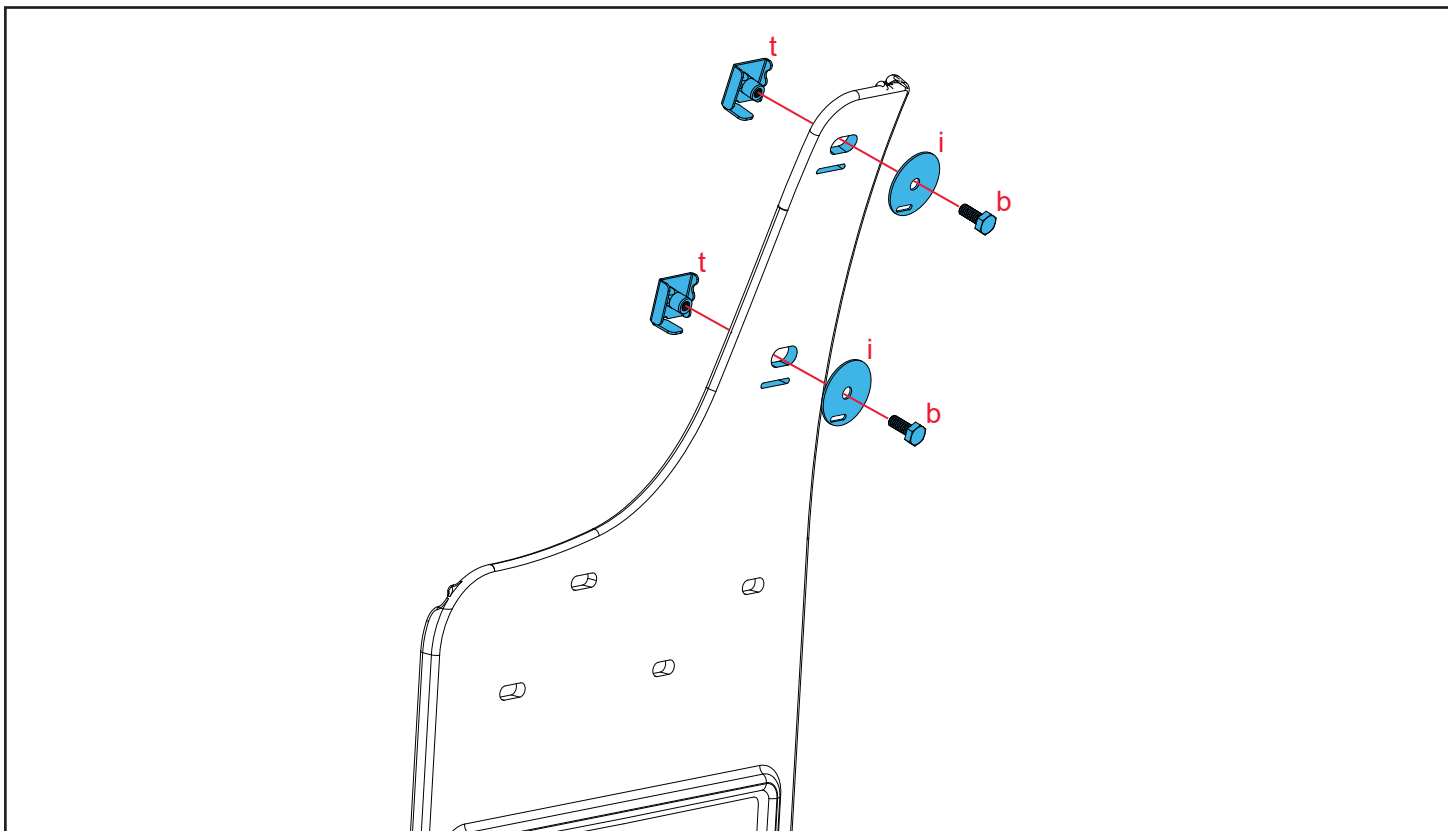

4-1 Loosely install mount clips to rubber as shown

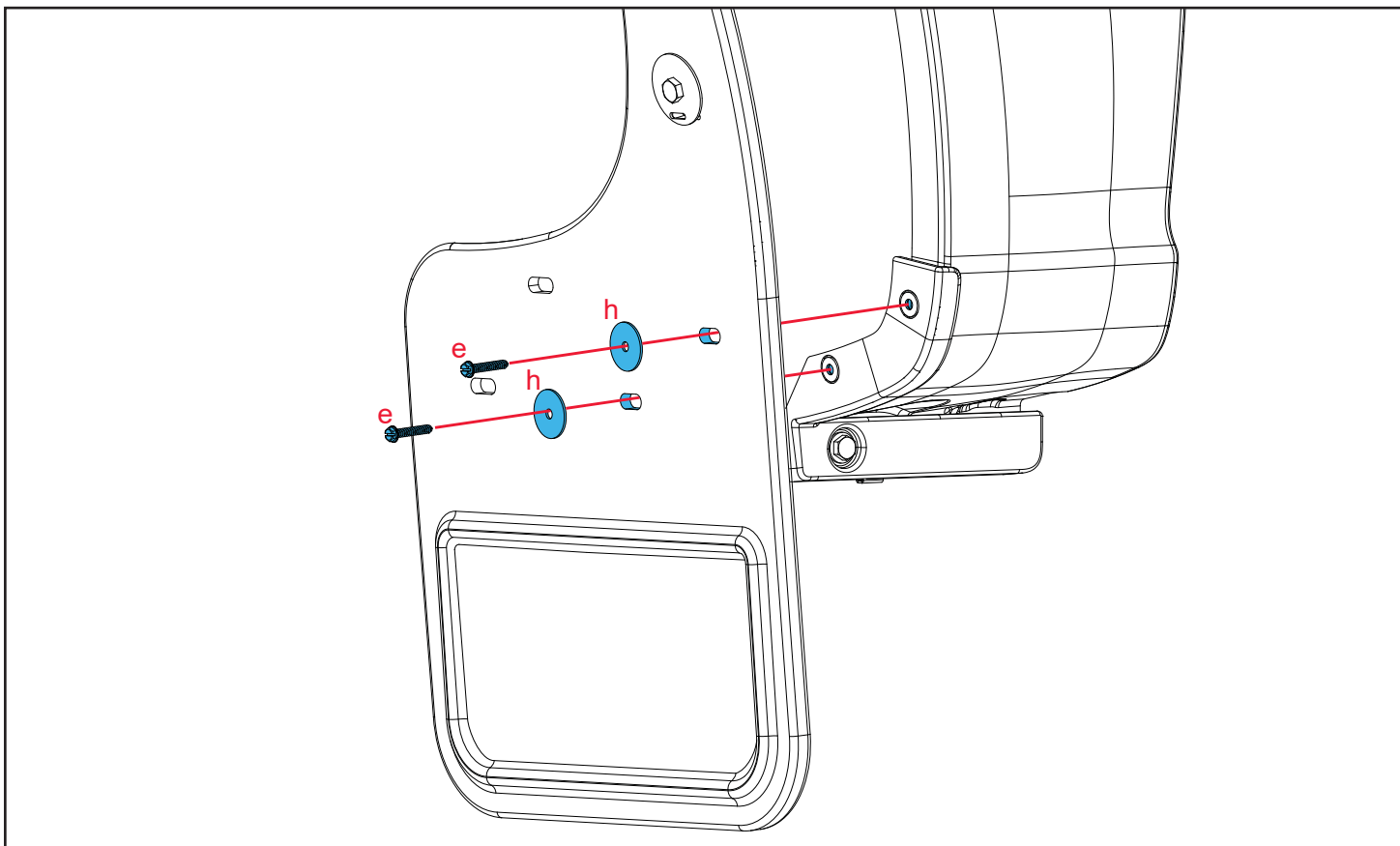

5-1 Loosely install hardware as shown

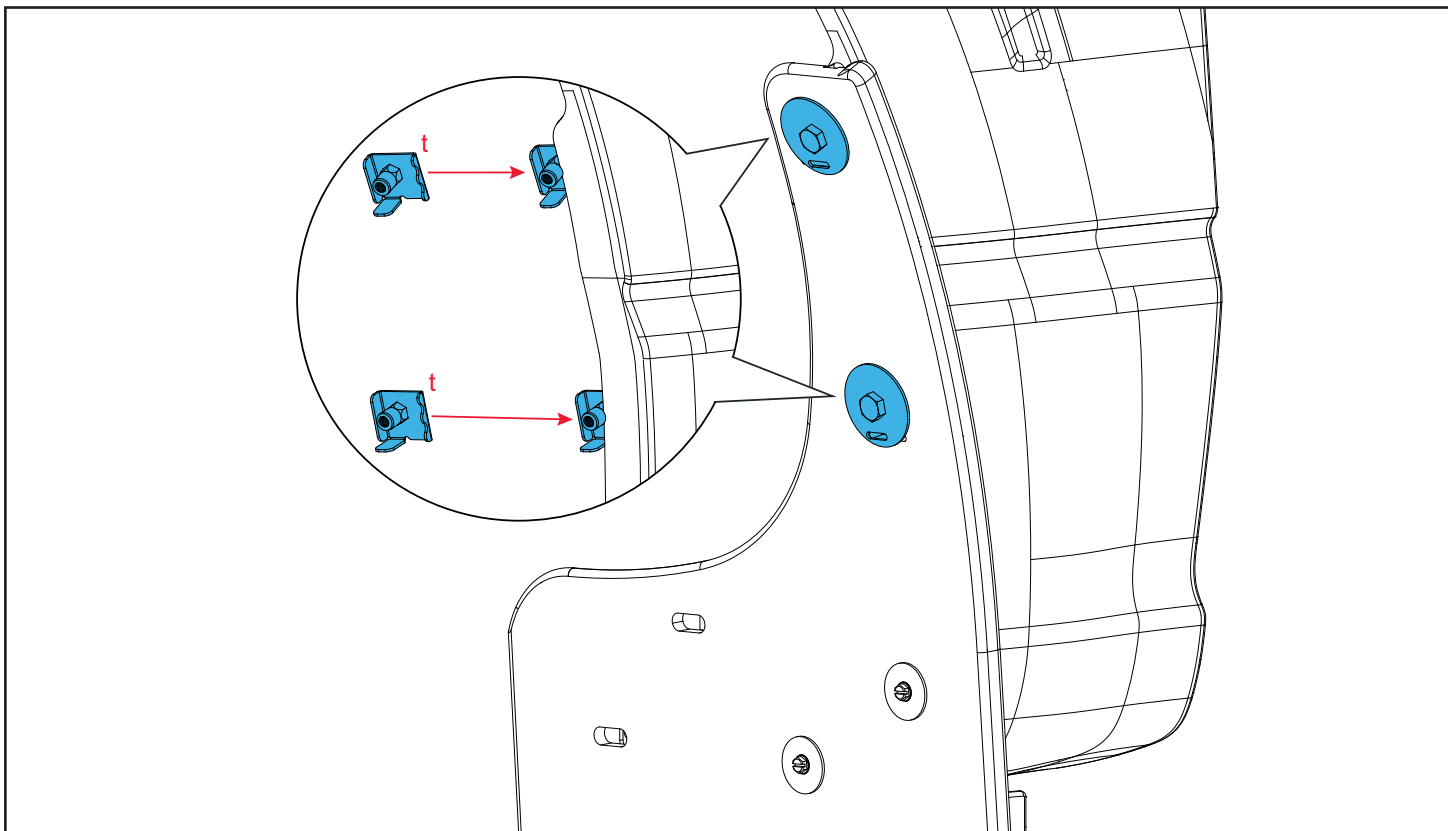

6-1 Slide mount clips behind fender lip as shown

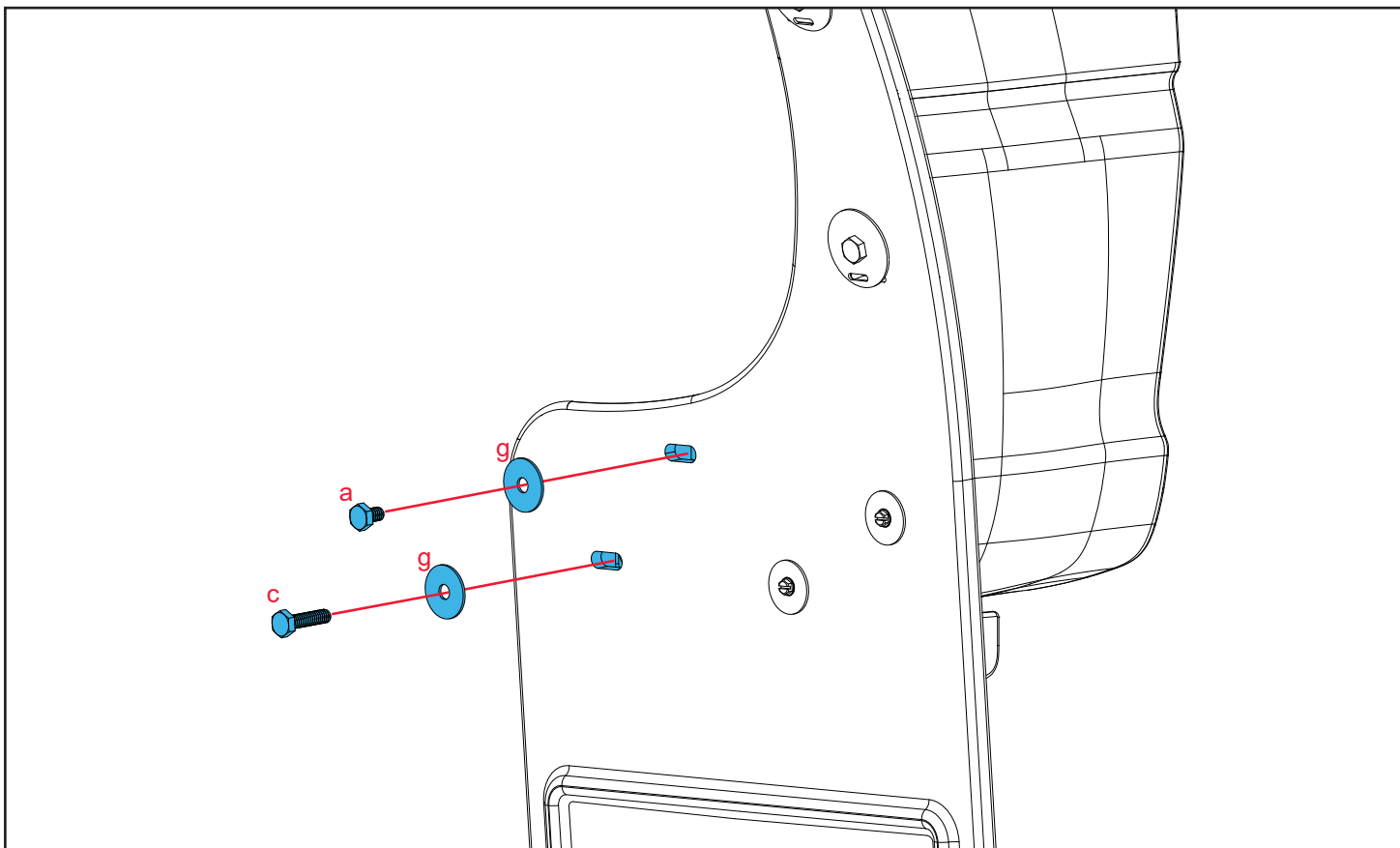

7-1 Loosely install hardware as shown

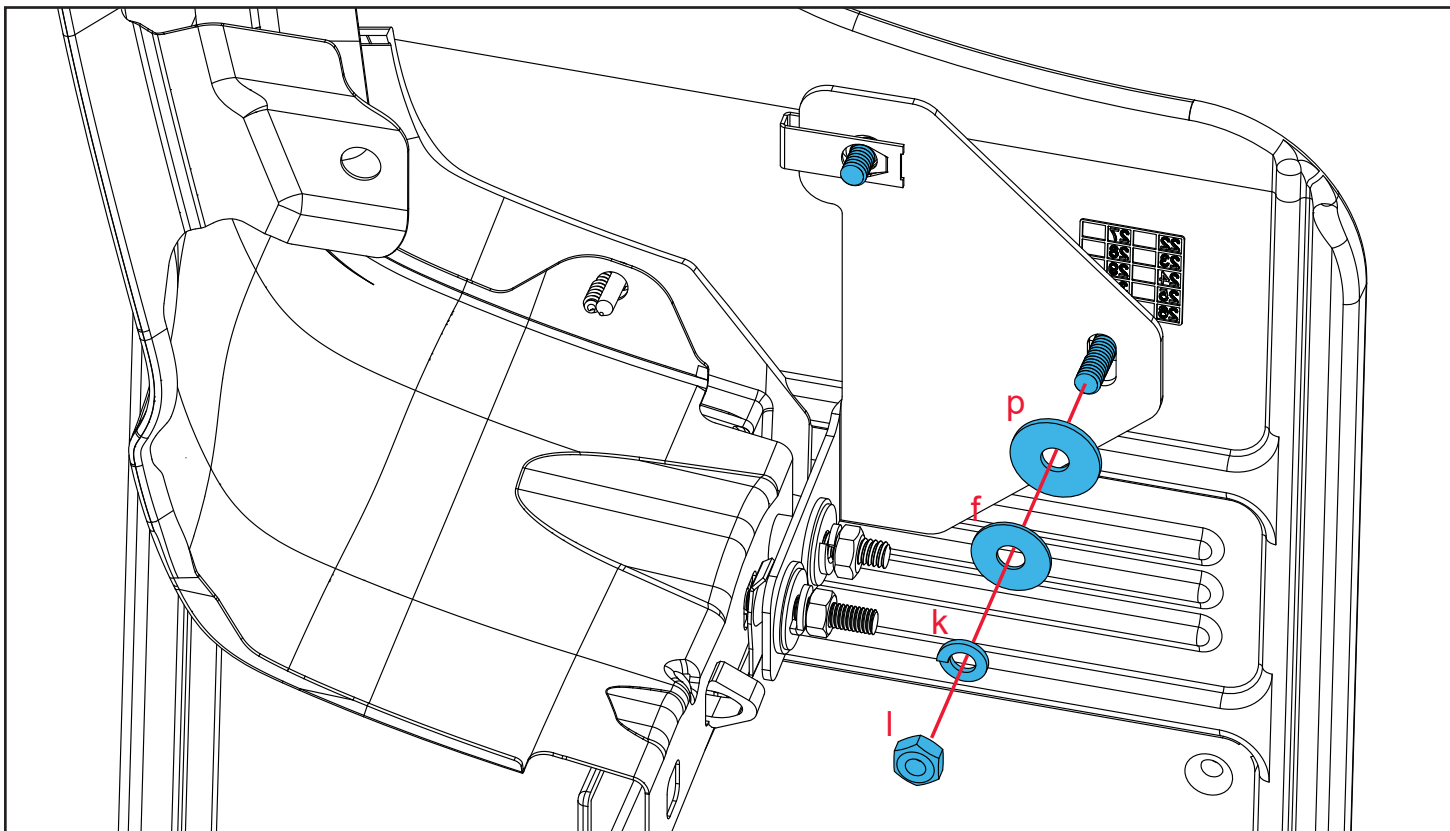

7-2 Secure hardware installed in step 7-1 as shown

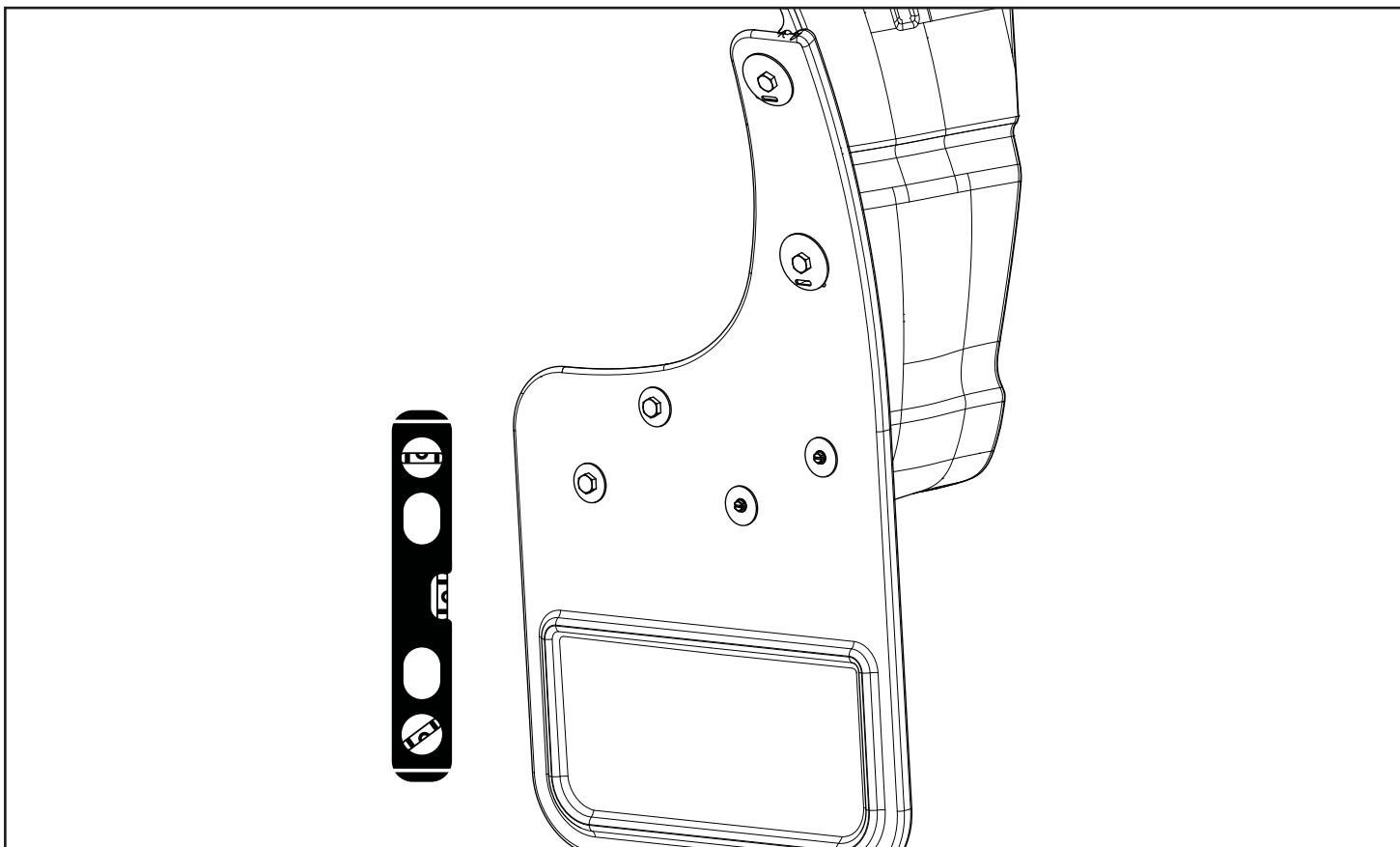

8-1 Use a level & visually determine that the mudflap is straight. Gently tighten all fasteners



Check out our YouTube channel for install video

www.truckhardware.ca





21-C Ford F-150

Mud Flap Set, Rear

Mounting Diagram & Instructions

Part# RCR408R

IMPORTANT:

Manufacturer is not responsible for negligent use of vehicle with mud flaps installed, including over-tightening of screws and bolts causing damage to vehicle or mud flaps.

TOOLS REQUIRED:



Push Pin
Removal Tool

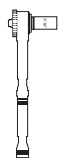

7/16" Open Wrench
and Socket Wrench

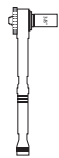

3/8" Open Wrench
or Socket Wrench



5/16" Open Wrench
or Socket Wrench



1/4" Open Wrench
or Socket Wrench

FLAPS AND BRACKETS

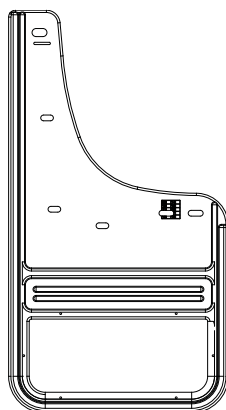

(1) Flap Rear, DS

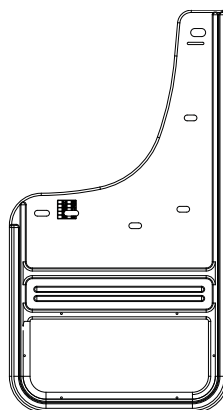

(1) Flap Rear, PS

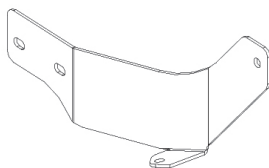

(1) Bracket Large Rear, DS
Part #769805

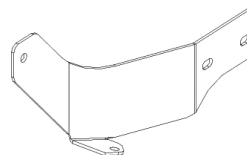

(1) Bracket Large Rear, PS
Part #769806



(1) Bracket Small Rear, DS
Part #770946

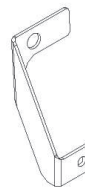

(1) Bracket Small Rear, PS
Part #770947

PARTS BAG: #770950

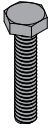

a) (6) Machine Screw, Blk Ox
#10 x 1"
Part #012050



b) (2) Capscrew, Blk Ox
1/4"-20UNC x 3/8"
Part #014069

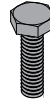

c) (6) Cap Screw, Blk Ox
1/4"-20UNC x 1"
Part #014073

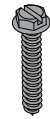

d) (2) Screw, Sheet Metal
#8-18 x 1.25" Blk Ox
Part #016061



e) (6) Washer, Flat
0.203" x 0.781", SS
Part #018018

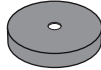

f) (2) Washer, Flat
5/16" x 1" x 1/4", HDPE
Part #018036

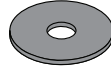

g) (6) Washer, Flat
0.281" x 1", SS, Blk Ox
Part #018069



h) (8) Washer, Flat
0.203" x 1", Blk Ox
Part #018070

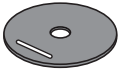

i) (4) Washer, Slotted
0.281" x 1.5", SS, Blk Ox
Part #018084



j) (2) Washer, Lock
1/4" Helicoil, SS
Part #024000



k) (6) Washer, Lock
8-18, #10 SS
Part #024001



l) (2) Hex Nut
1/4"-20, SS
Part #025000



m) (6) Hex Nut
#10-24, SS
Part #025003



n) (2) Spring Nut
#8, 9/16" Reach
Part #028004



o) (4) Spring Nut
1/4"-20UNC, 0.84" Reach
Part #028010

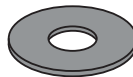

p) (4) Washer, Nylon
0.318"x1" x 0.04"
Part #054061



q) (6) Washer, Nylon
0.203" x 0.885" x .062"
Part #054080



r) (2) Washer, Nylon
0.281" x 1" x 0.11"
Part #054084



s) (1) Mount Clip
Driver Side
Part #769308



t) (1) Mount Clip
Passenger Side
Part #769309

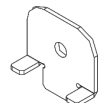

u) (2) Wedge Plate
Universal
Part #770747

INSTALLATION INSTRUCTIONS *(for ease of installation it is suggested that the wheel be removed)*

Note: Before you install your mudflap set, see the diagram & parts list for all necessary parts

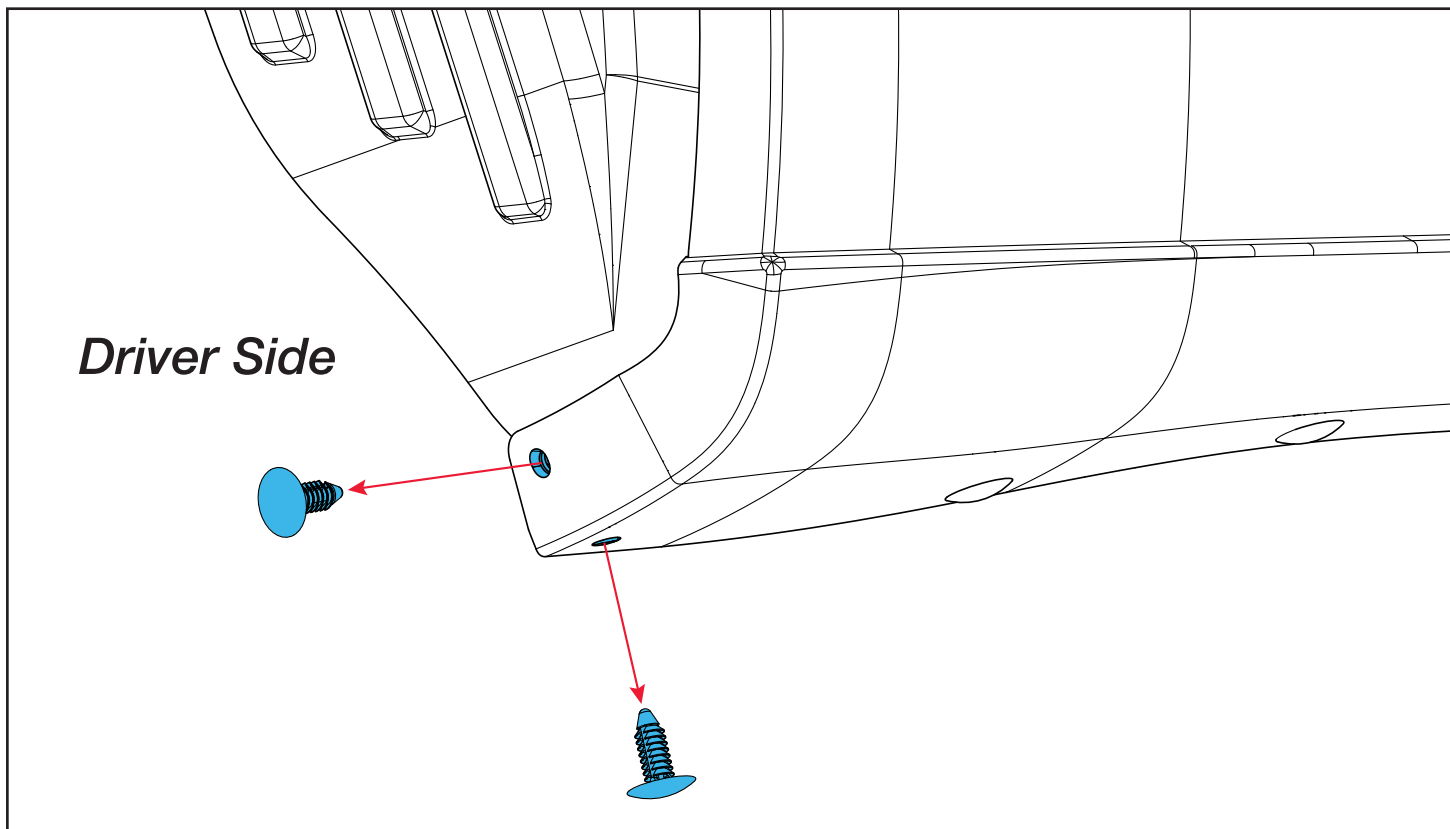

1-1 Remove factory hardware as shown

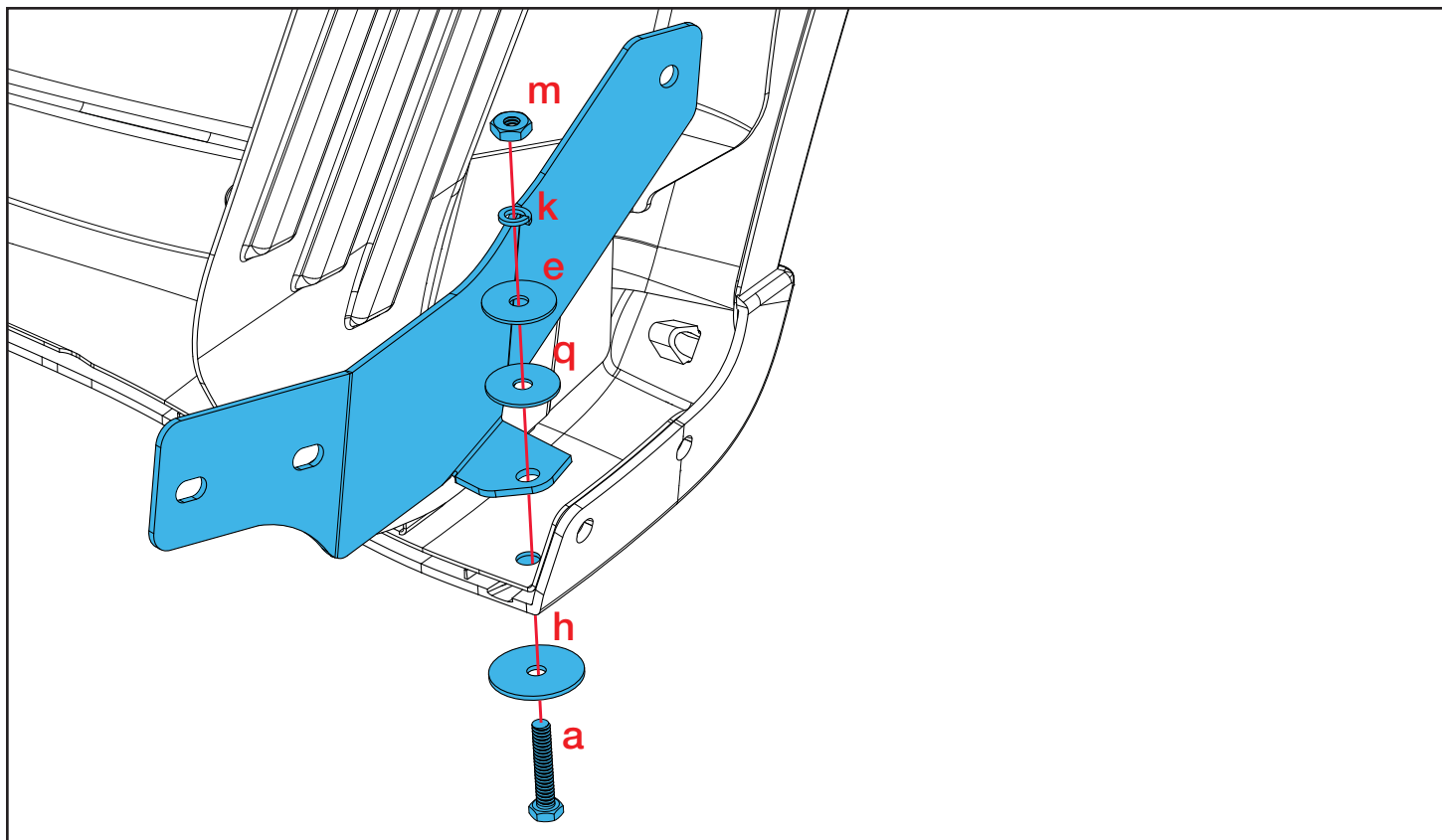

2-1 Loosely install bracket & hardware as shown

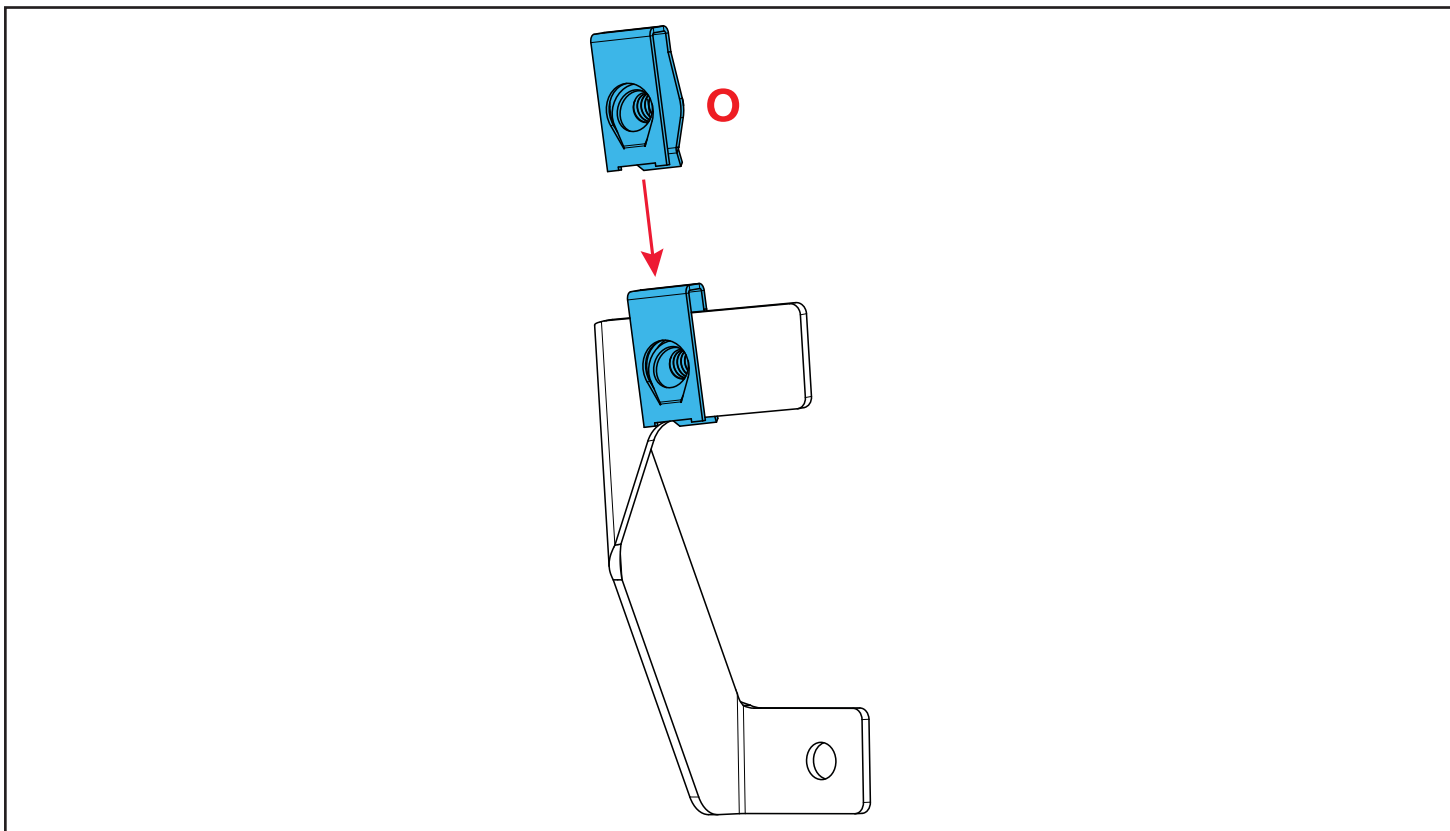

3-1 Install spring nut on bracket as shown

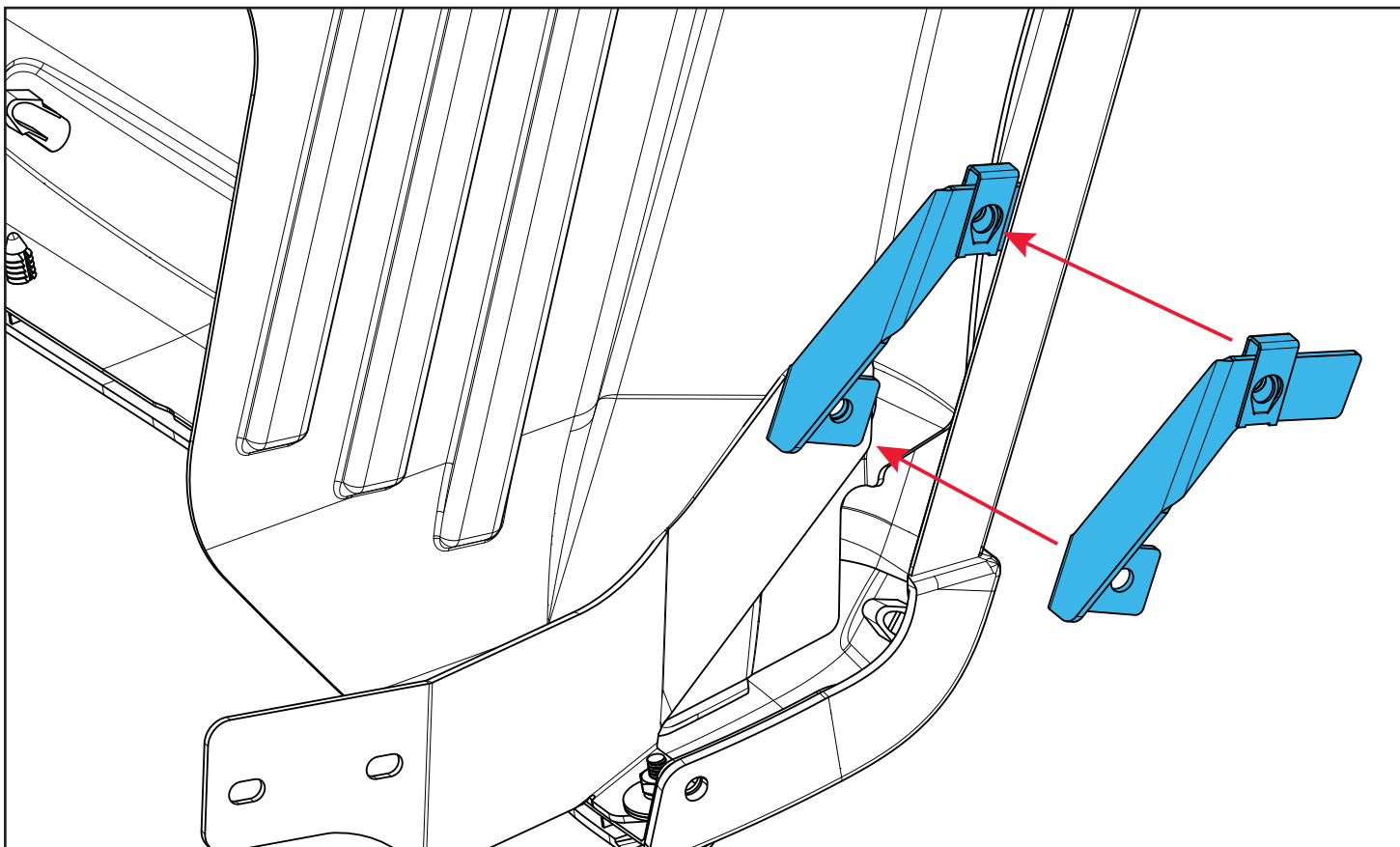

4-1 Ensure the small bracket is aligned so the edge of the top of the bracket is resting snugly against the sheet metal behind the wheel lip. Begin installing the small bracket to large bracket as shown in step 4-2

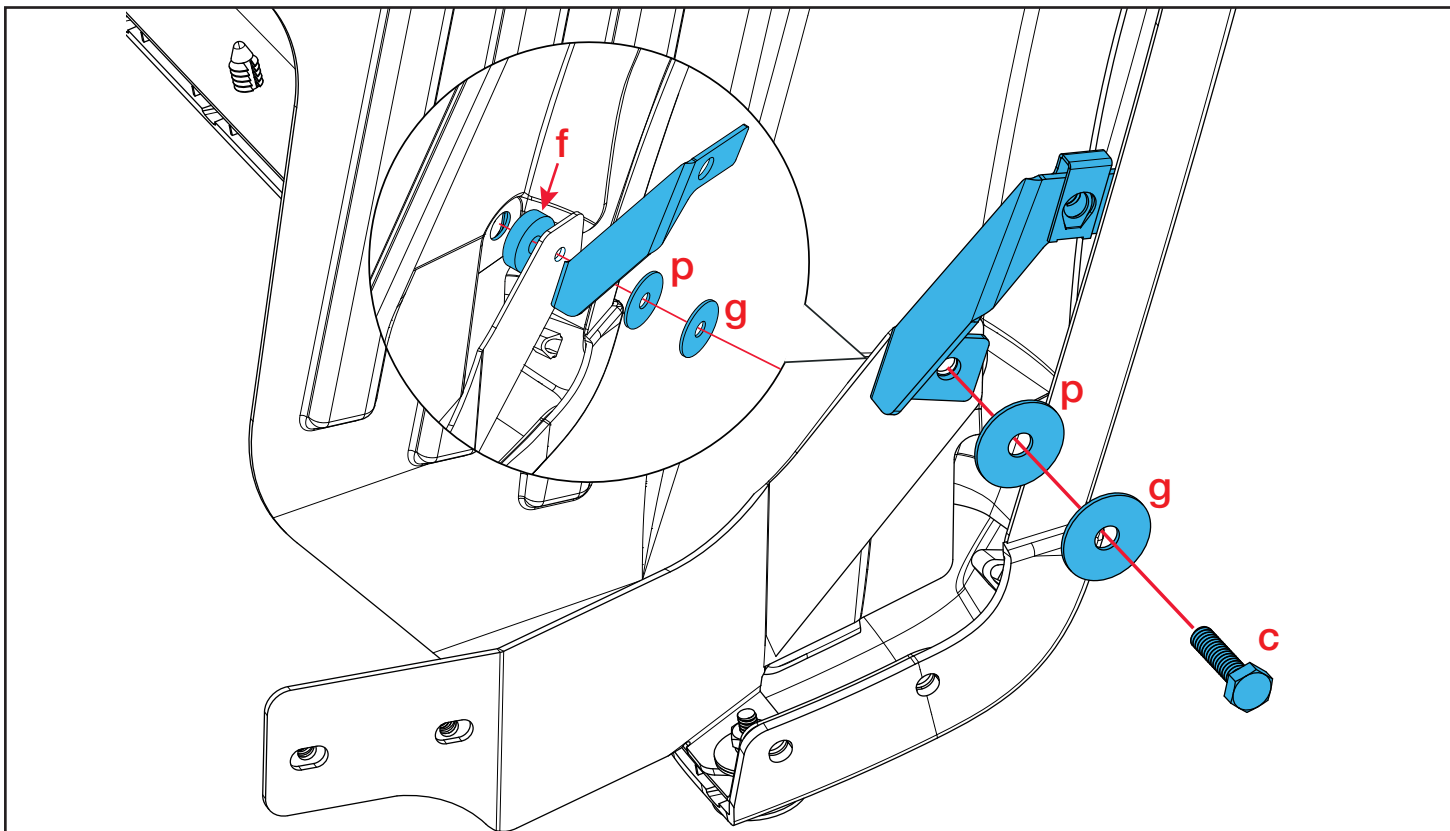

4-2 Install small bracket to large bracket as shown. Be sure to insert spacer (f) before securing the bracket in step 4-3

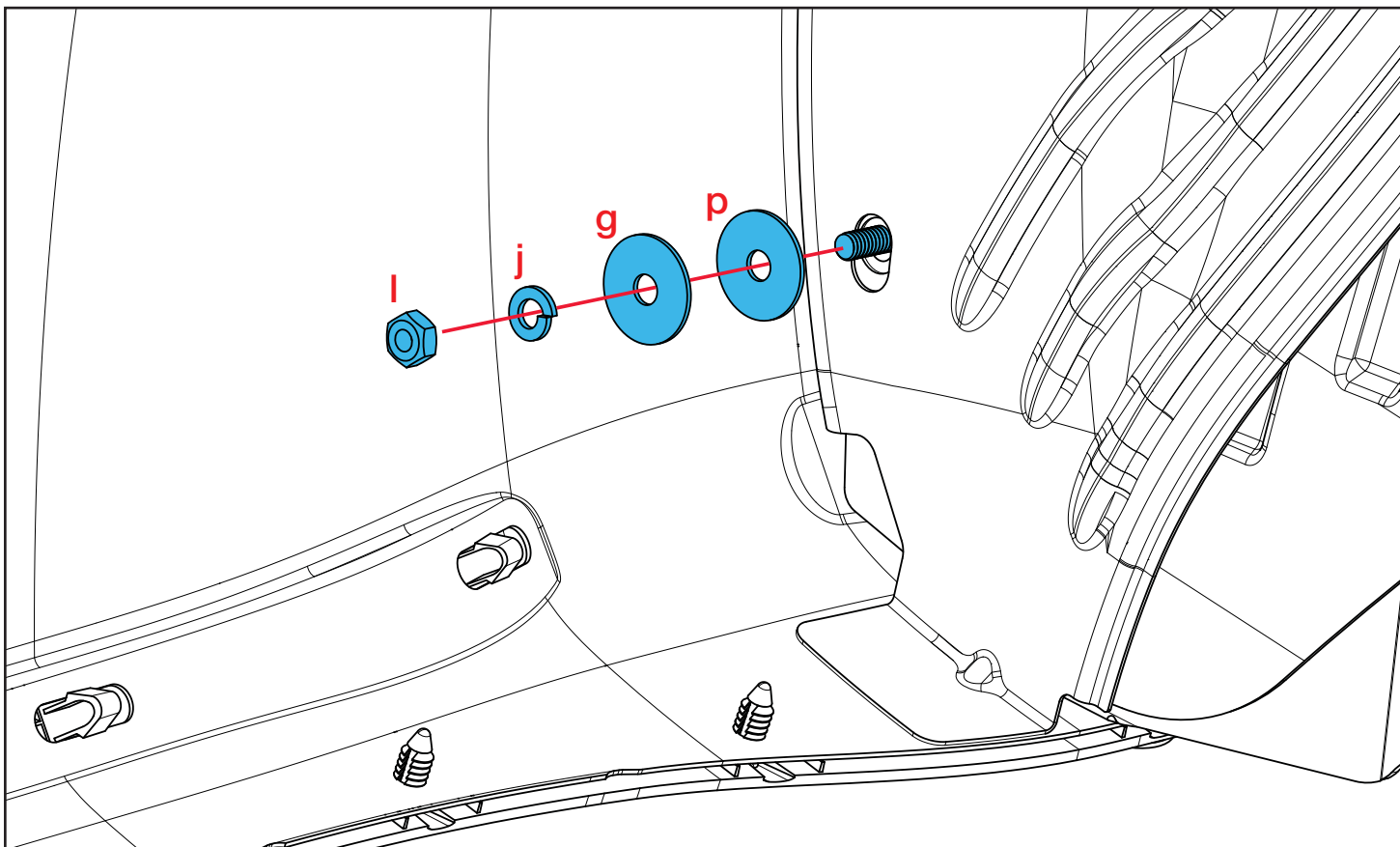

4-3 Secure hardware installed in step 4-2 as shown

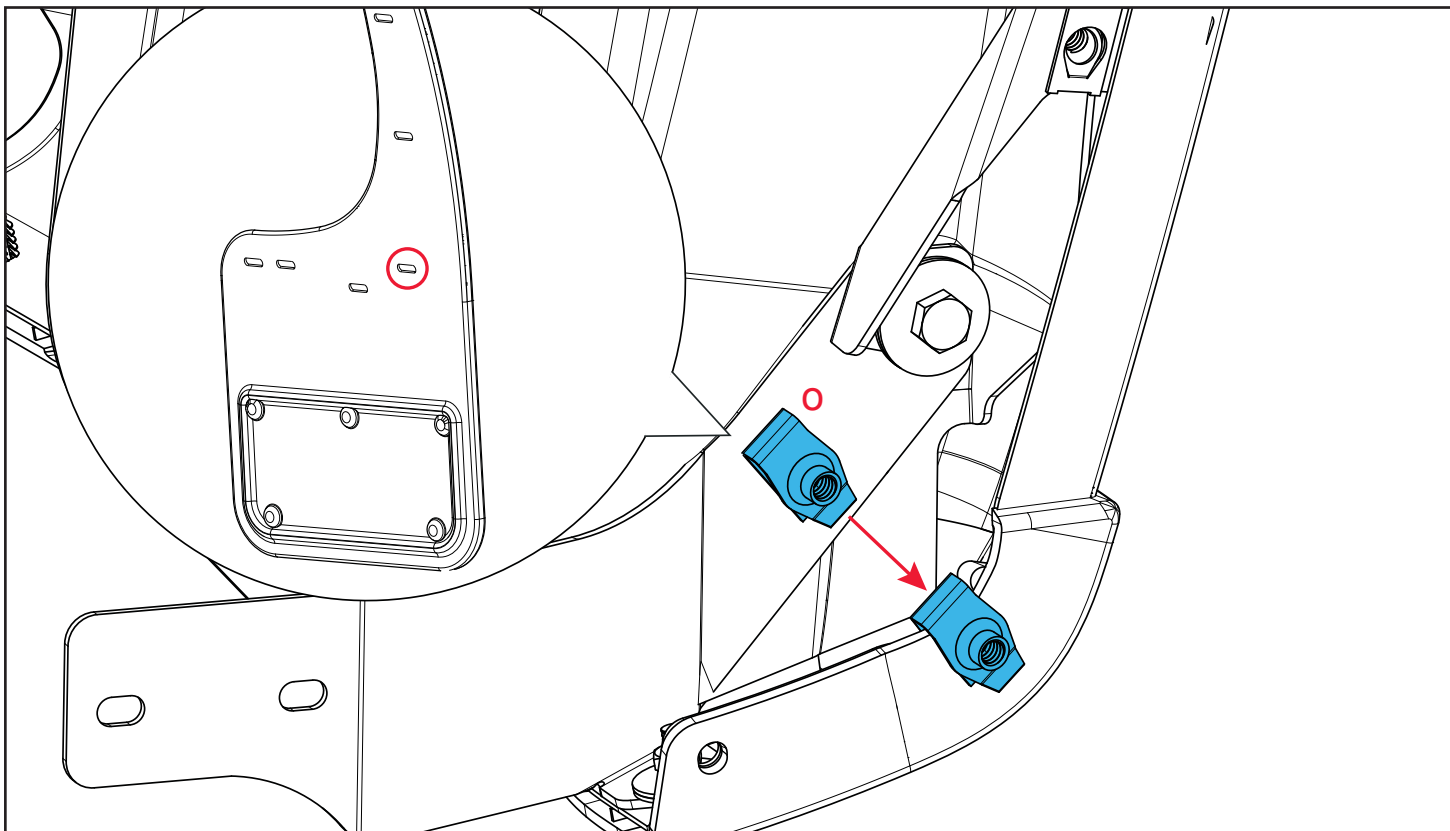

5-1 Install spring nut over plastic guard, aligning it with the hole shown in the diagram

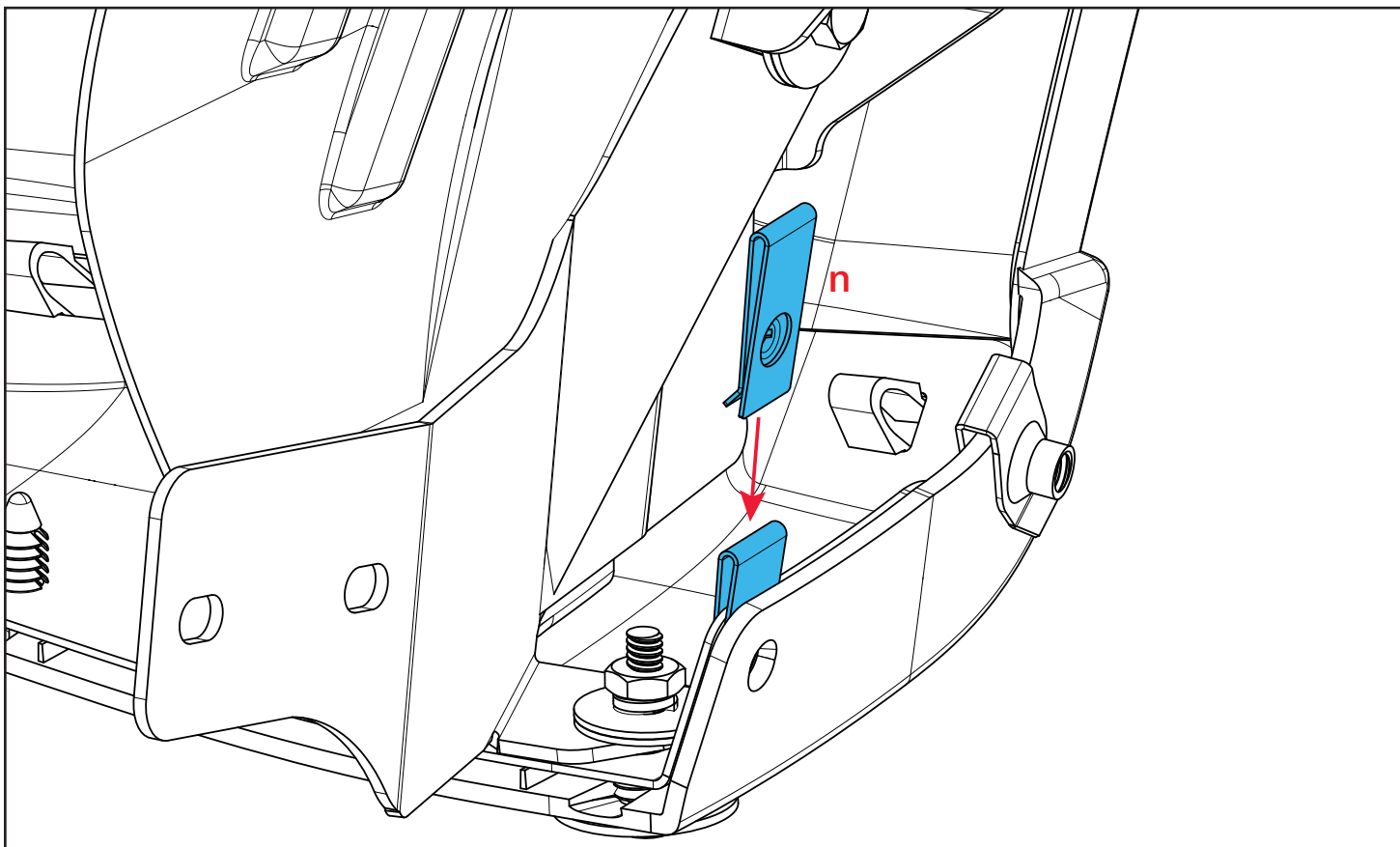

6-1 Install spring nut over factory hole on the sheet metal as shown

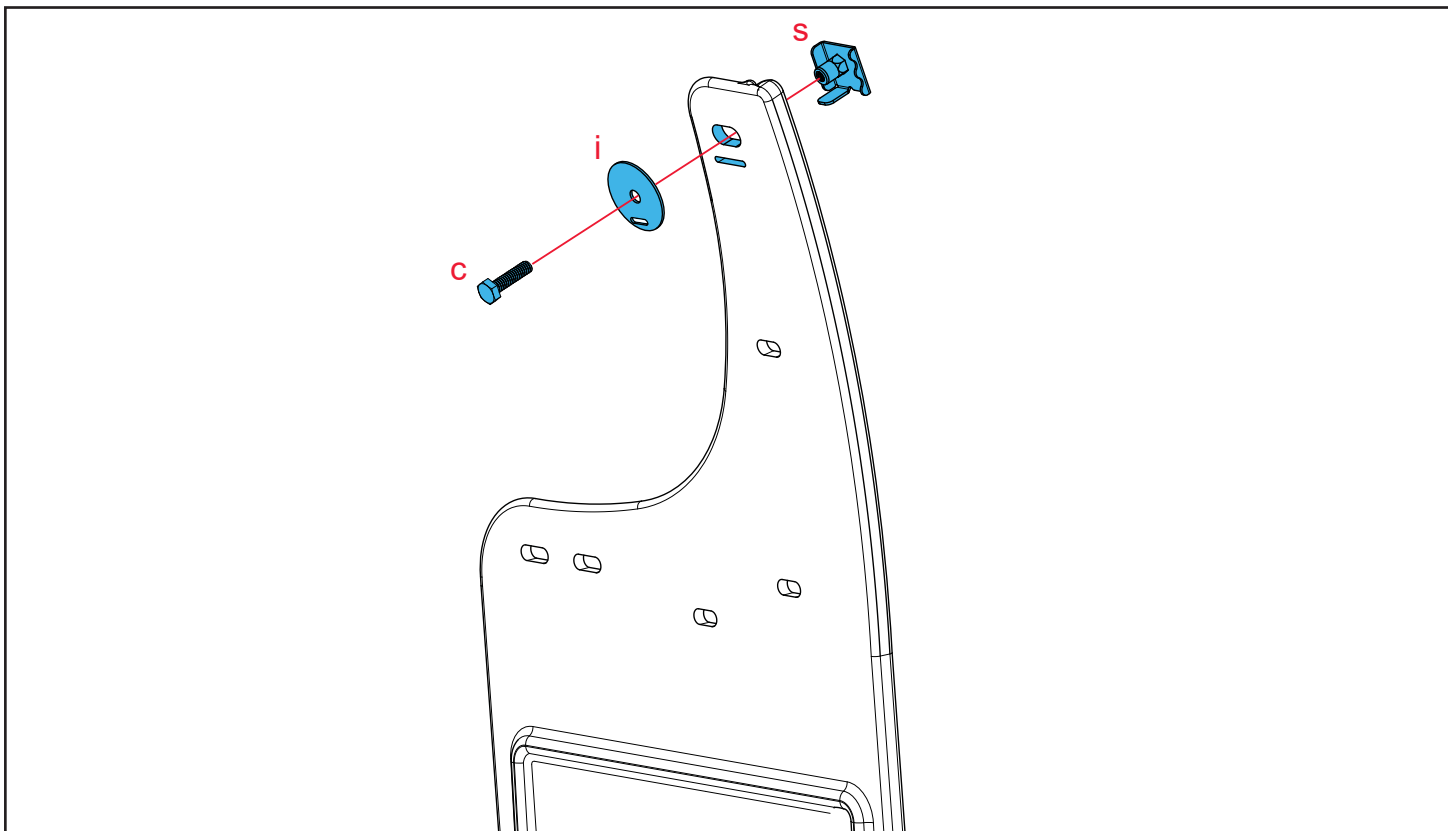

7-1 Loosely install mount clip on rubber as shown

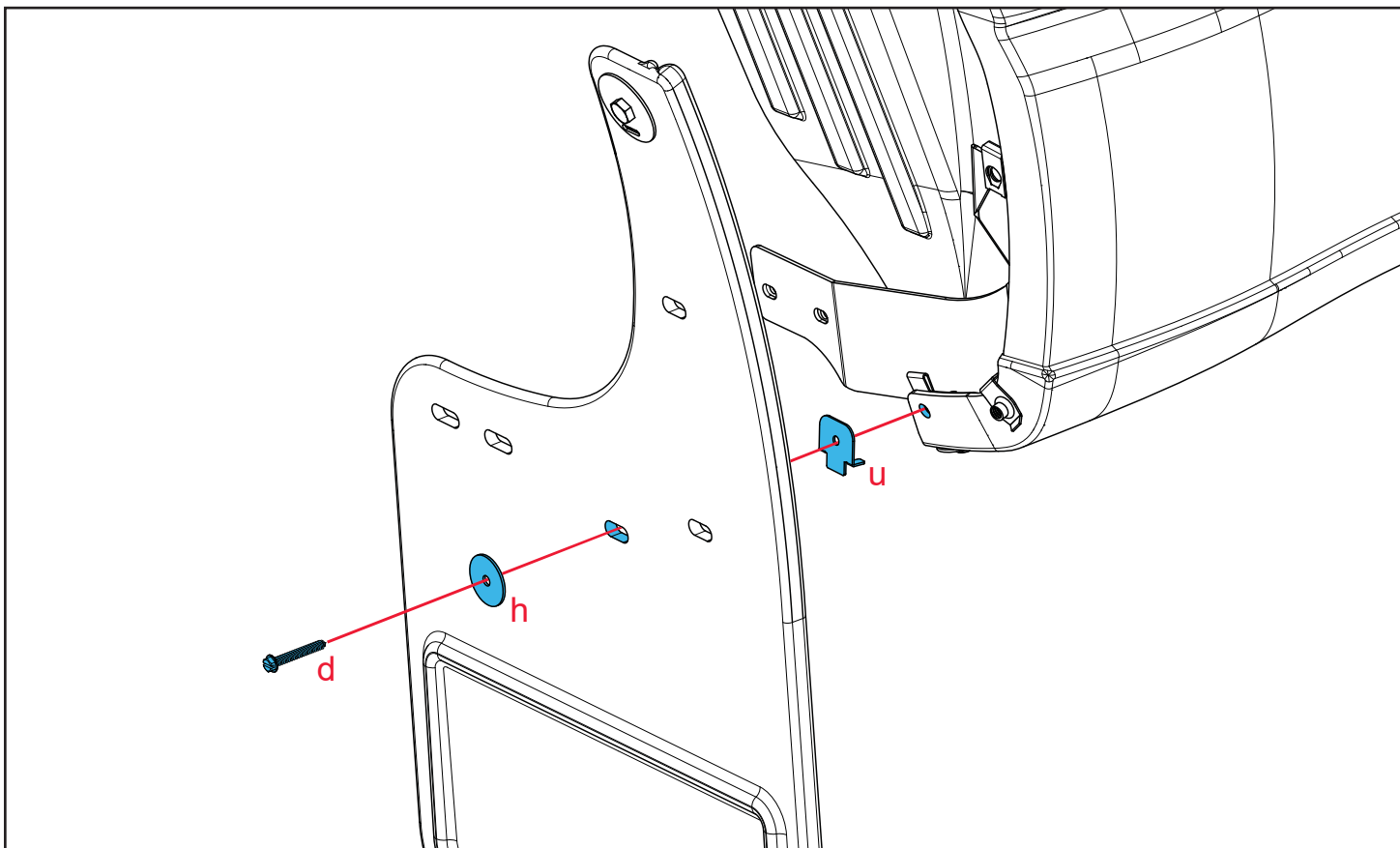

8-1 Loosely install hardware as shown. Ensure wedge plate is between rubber & fender lip

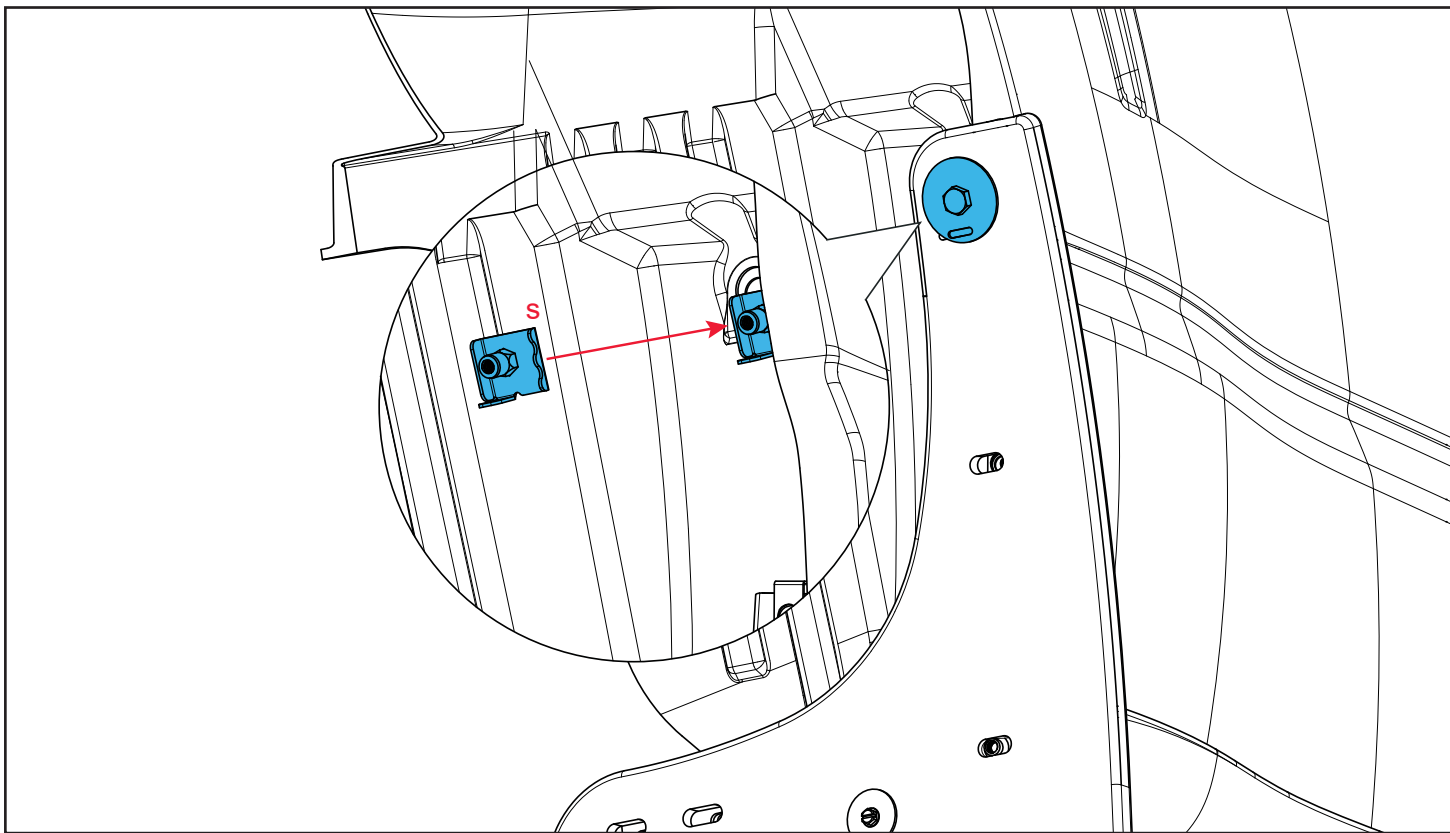

9-1 Slide mount clips behind fender lip as shown

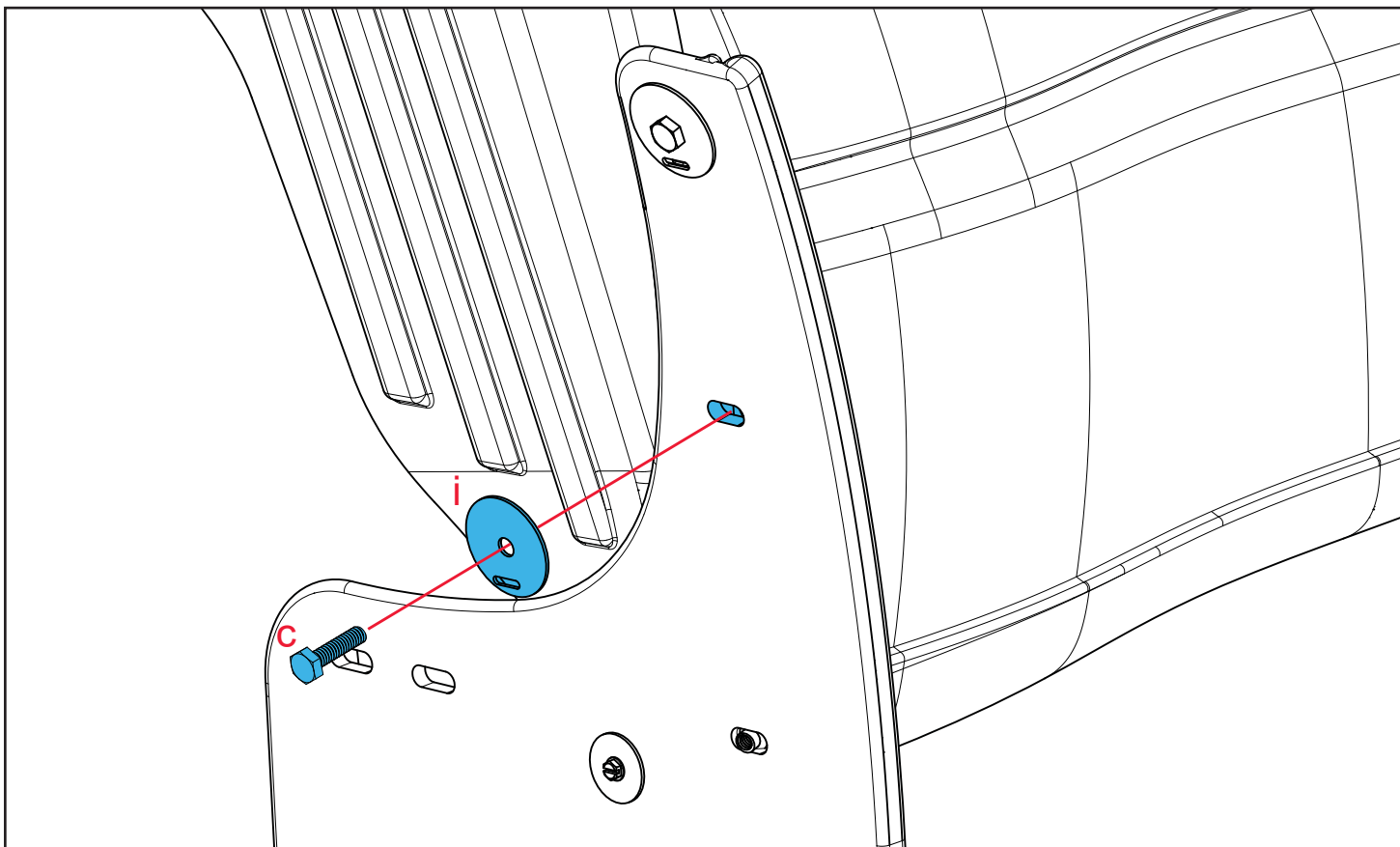

10-1 Loosely install hardware as shown

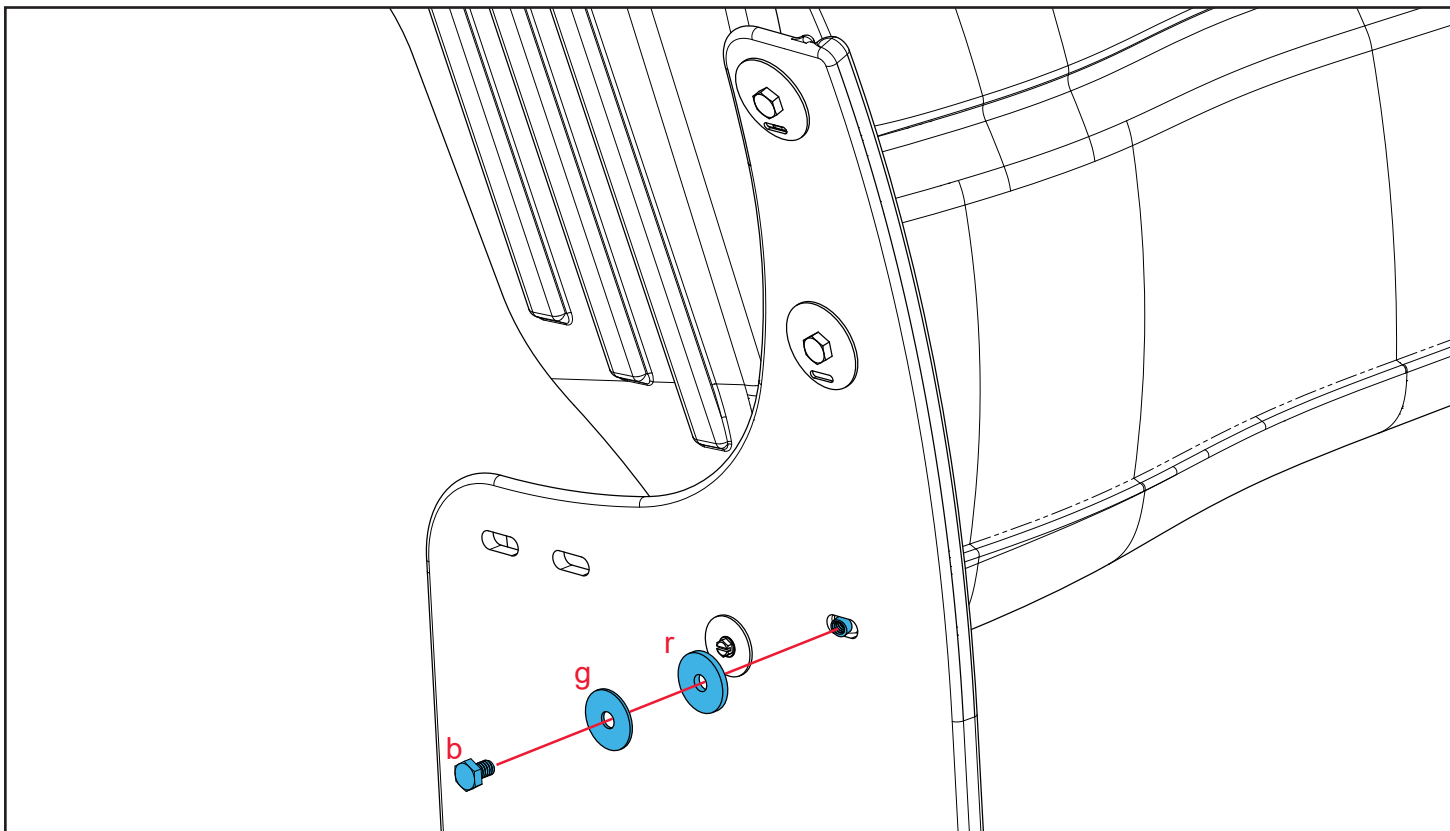

11-1 Loosely install hardware as shown

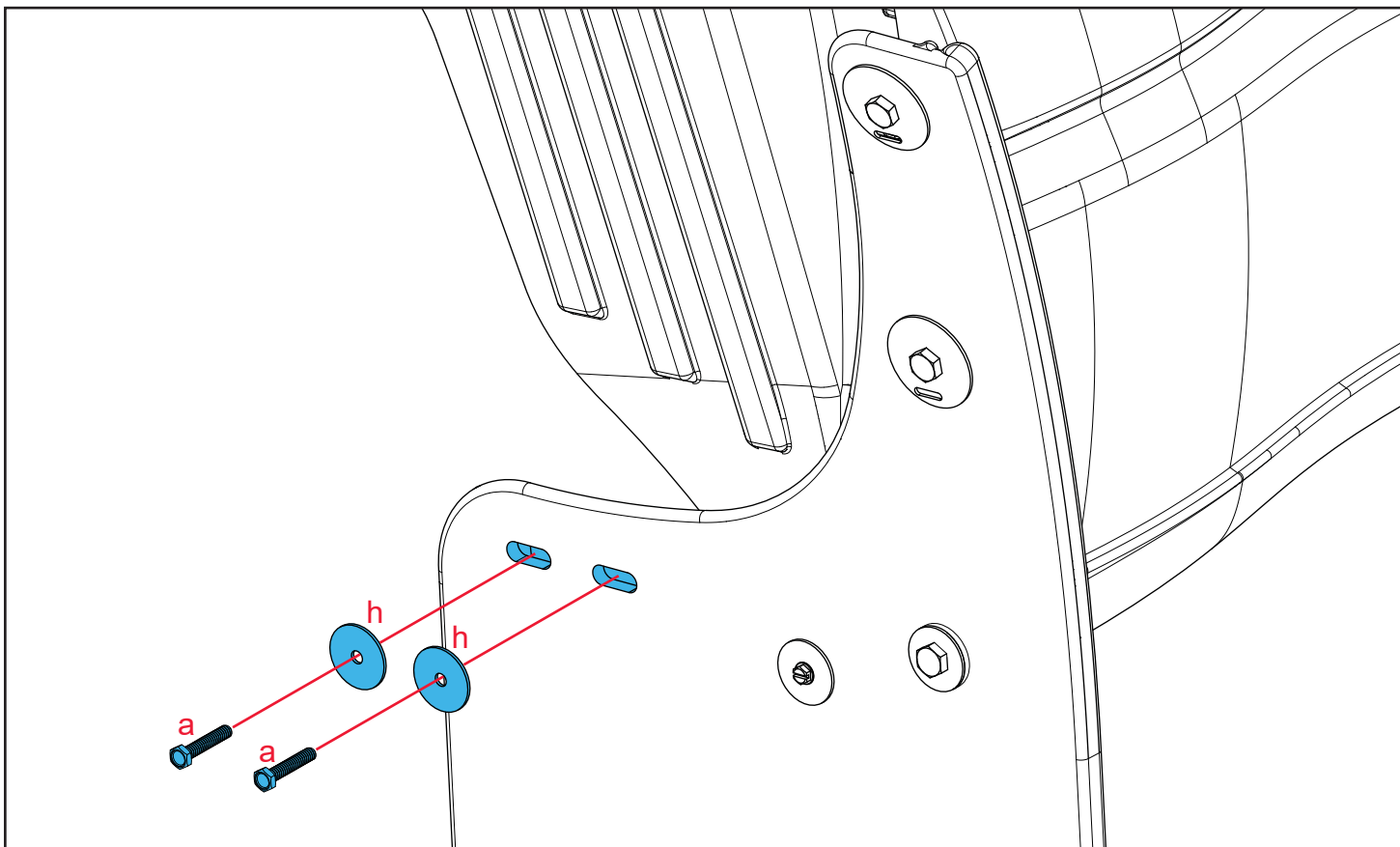

12-1 Loosely install hardware as shown

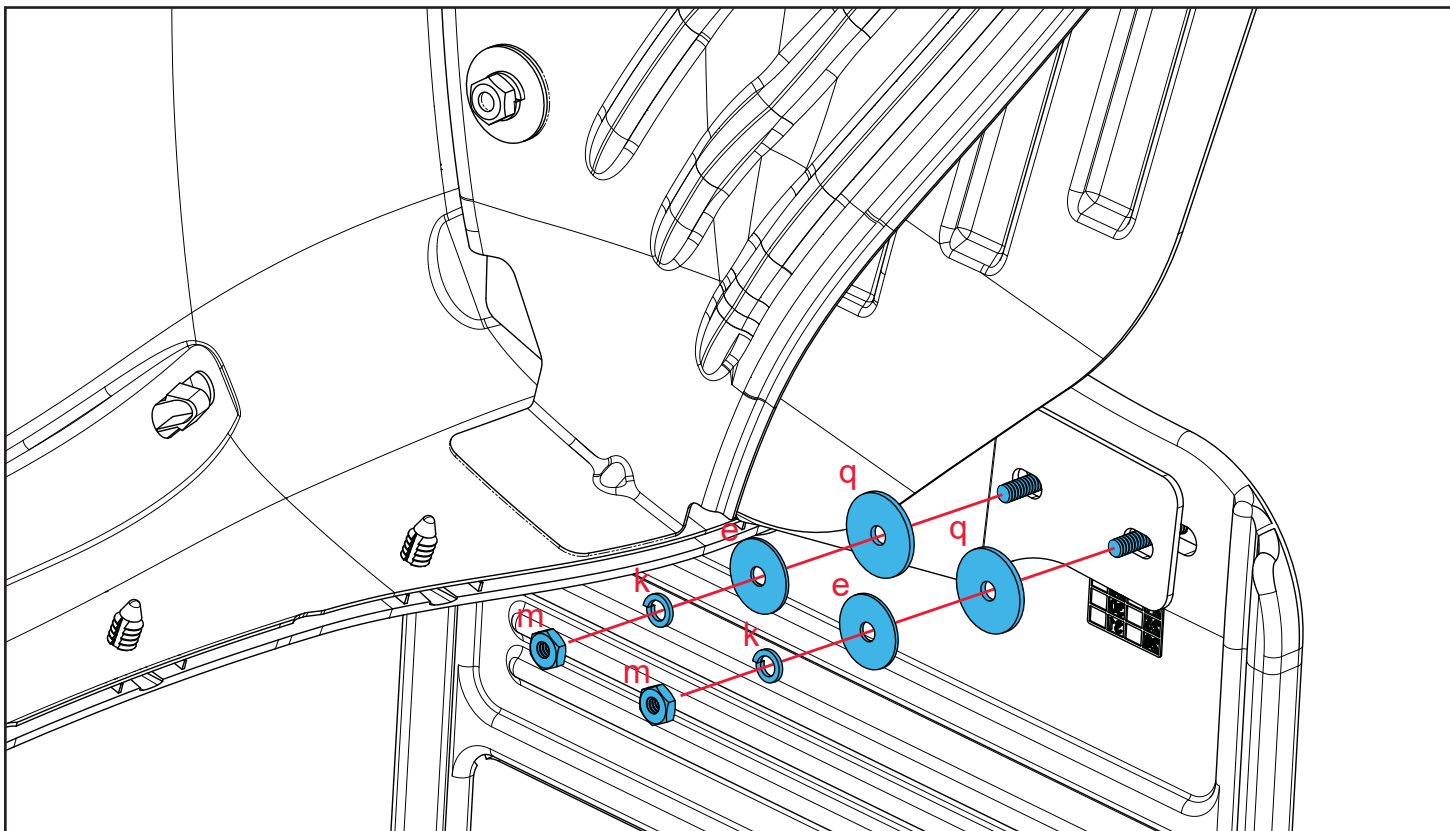

12-2 Loosely secure the hardware installed in step 12-1

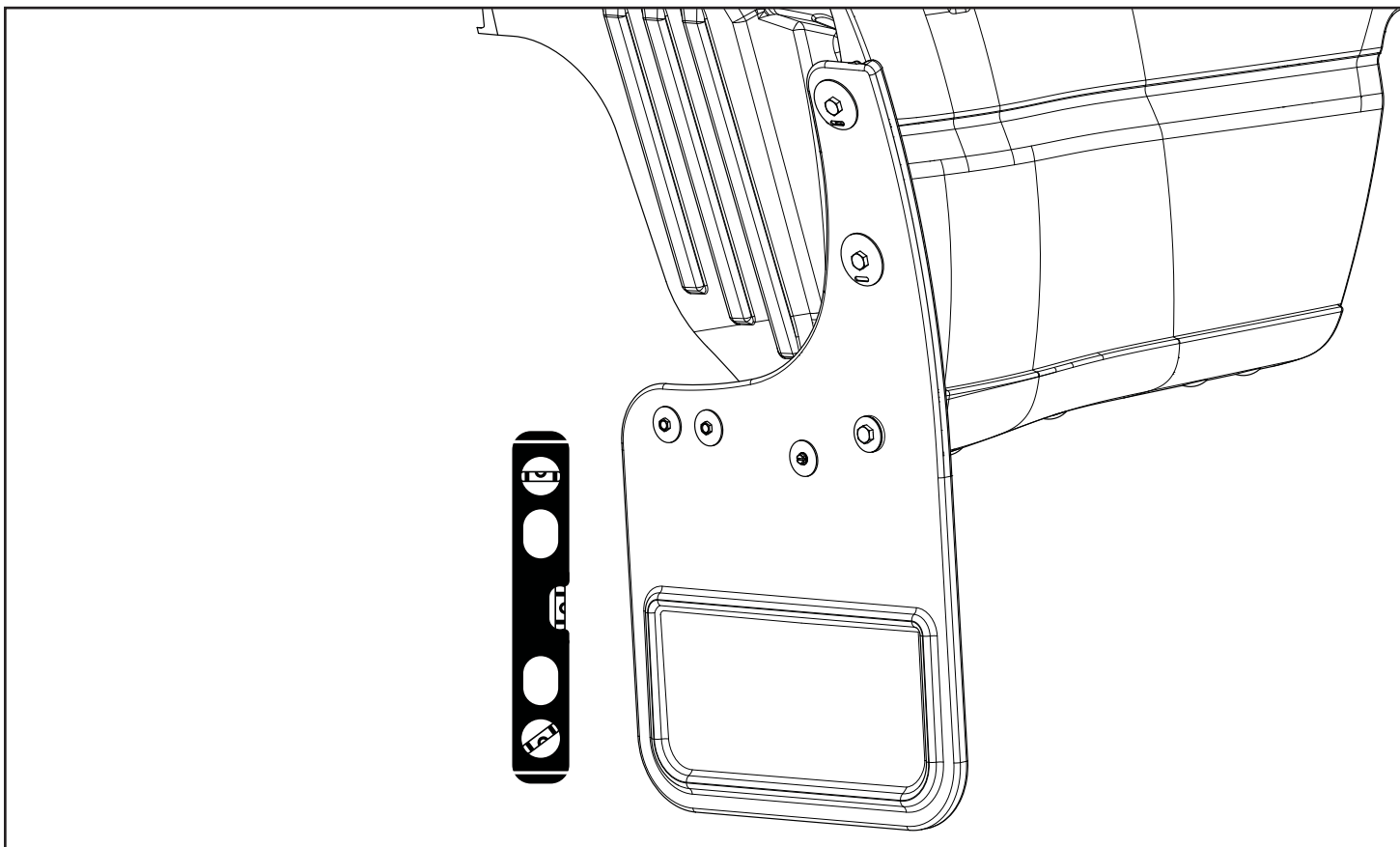

13-1 Use a level & visually determine that the mudflap is straight. Gently tighten all fasteners



Check out our YouTube channel for install video

www.truckhardware.ca

