

Input Voltage	Max Power Draw Red – 48" / 60"	Max Power Draw White – 48" / 60"
12-15V DC	13W / 18W	10W / 12W

### Warranty and Disclaimer

**Within THREE years after the purchase date, the original buyer** may return any XKGLOW products that has one or more LEDs that fail to illuminate, due to a defect in materials or workmanship.

Installation of this product must be performed by a licensed professional. Should the failure of the product be the result of damage occurring as a result of improper installation, alteration of the product or an act or omission on the part of the consumer, this warranty is void. XKGLOW Lighting shall not be responsible for any consequential damages which arise from the use and/or installation of the product. If the kit is installed in any manner other than specified, XKGLOW Lighting reserves the right to deny any warranty claims at the discretion of the technical support department. Any product return must include the original packaging, invoice number and a statement of the alleged defect. Upon receipt of the returned product, the company will test the product for defect. If the results of the testing do not support the warranty claim, do not reveal any defect or indicate consumer negligence in the installation and handling of the product, then the product will be returned to you and you will be charged a reshipping fee. If the product is returned from an address within the continental United States, within the first 30 days after purchase, and is found to be defective, XKGLOW Lighting will exchange or refund the original purchase expense. This offer does not extend to the cost for shipping charges on any international packages.

### Additional Disclaimer Terms

Please check your local and state laws for the proper use of this product.

- Improper installation of electrical products such as lighting may cause damage to any vehicle or device to which the improperly handled or installed lighting is attached.
- Improperly installed product may cause electrical injury to persons.
- Installation of this product must be performed by a licensed professional.
- XKGLOW assumes no liability for the installation of the product.
- Warranty or liability will not exceed the product purchase price, which shall be buyer's sole and exclusive remedy.
- 

### Return/Exchange Procedure

1. Email [xk@xkglow.com](mailto:xk@xkglow.com) to notify us of the product issue as well as the item number and name of customer on invoice.
2. We will send you the trouble-shooting guide to fix the issue, or to narrow down which of the component(s) need to be replaced. If the issue still exists, we will ask you to send back the defective items to be replaced.
3. Please send the returned item as instructed, along with claims and a telephone number where you can be reached.
4. After the returned item(s) have been accepted and inspected, we will issue a refund or replace the items ASAP. For refunds, item(s) must be sent to XKGLOW within 14 days from date of purchase. Original shipping charges are not refundable.

We always stand behind our products and are committed to our customers! For questions you may have, please contact [xk@xkglow.com](mailto:xk@xkglow.com). We normally respond within 24 hours. (Monday-Friday).

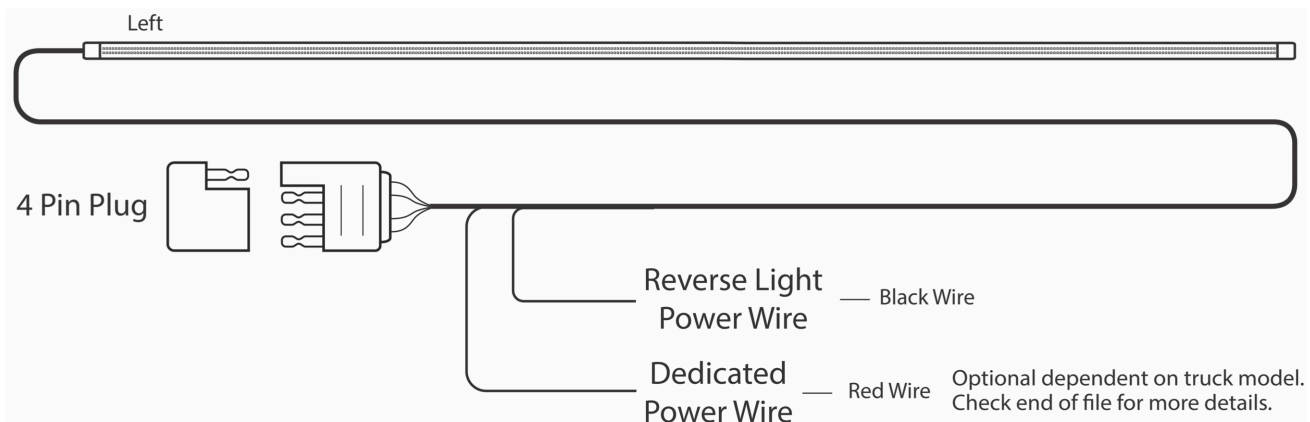

## Mounting Instructions

### Permanent Mounting:

1. **Test light bar:** Before mounting, plug light bar into 4 pin trailer plug. With the vehicle off, turn on hazards and check operation.
2. **Prep mounting surface:** Using isopropyl alcohol, thoroughly clean the mounting surface. Let dry. Any dirt or debris left on the paint will prevent the light bar from adhering properly.
3. **Position light bar:** Remove red tape backing and loosely position the light bar onto the vehicle. Do not press firmly! Step back to ensure that light bar is centered and straight. Once in position, firmly and thoroughly press onto the vehicle. *Please note that the wiring must exit towards the **LEFT** side of the vehicle.*

### Removable Mounting:

4. **Test light bar:** Before mounting, plug light bar into 4 pin trailer plug. With the vehicle off, turn on hazards and check operation.
5. **Prep mounting surface:** Using isopropyl alcohol, thoroughly clean the mounting surface. Let dry.
6. **Install brackets:** Evenly space and snap the brackets onto the light bar. With the brackets snapped onto the light bar, use masking tape and loosely position the bar into place on the vehicle. Ensure light bar is centered and straight and mark the position of each bracket. Remove the light bar and using the self-tapping screws, secure the brackets to the vehicle.
7. **Install light bar:** Insert the top of the bar into the brackets first and then push the bottom of light bar into the brackets. *Please note that the wiring must exit towards the **LEFT** side of the vehicle.*

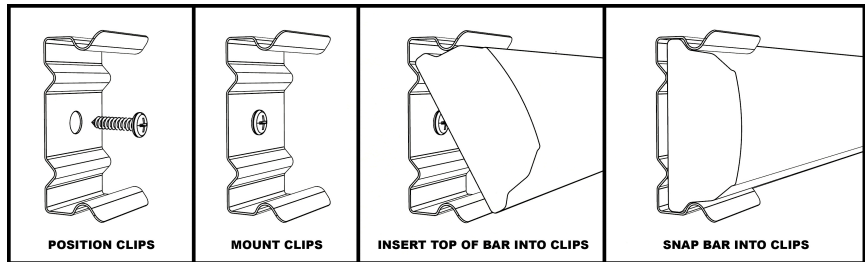

## Wiring Options

### For Trucks without Trailer Detection:

1. Plug the 4 pin plug on the truck tailgate light bar into the 4 pin trailer plug on the truck.
2. Wire in reverse light. Using the supplied red scotchlok, tap the additional black wire into the center wire on the 7 pin plug or into the factory reverse light positive wire behind one of the tail lights. See service manual for vehicle's reverse + wire color.
3. Power on vehicle and test functionality.

### For Trucks with Trailer Detection:

1. Remove the tail lights from the vehicle to gain access to the wiring.
2. Cut off the 4 pin plug from the truck tailgate light.
3. Using the supplied scotchlocks, tap the black, red, and green wire into its corresponding wire behind the **left** side tail light. See diagram to the right for plug pinout.
4. The yellow wire will be tapped into the turn signal positive wire on the **right** side of the vehicle. The included extension wire is to reach the right side of the vehicle. Use one of the scotchlocks to extend the yellow wire and another scotchlok to tap into the right side turn signal positive wire.
5. Wire in reverse light. Using the supplied red scotchlok, tap the additional black wire into the center wire on the 7 pin plug or into the factory reverse light positive wire behind one of the tail lights. See service manual for vehicle's reverse + wire color.
6. Secure any loose wiring and reinstall the tail lights.
7. Power on vehicle and test functionality.

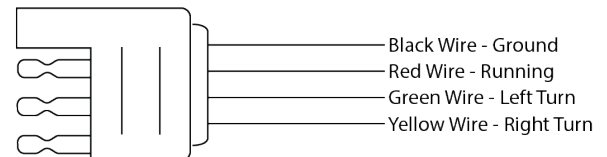

### If truck shows any of the following issues, the **dedicated power wire** will need to be connected to 12V.

- Trailer detection warning
- Trailer light out warning
- Tail lamp out warning
- Blind spot detection warning
- Flickering of light bar on any function

Take the RED wire coming directly from the tail gate bar and connect to a constant fused 12V power. This could be directly to the + battery terminal with a dedicated inline fuse or the 12V wire on the 7 pin trailer plug. Please note: 12V wire on the 7 pin trailer plug must be switched to constant-on power to ensure proper function.