



2014-2018 Toyota Tundra
Mud Flap Set, Rear
Mounting Diagram & Instructions
Kit# GCR82R
766527

IMPORTANT:

Manufacturer is not responsible for negligent use of vehicle with mud flaps installed, including over-tightening of screws and bolts causing damage to vehicle or mud flaps.

NO-DRILL SYSTEM

TOOLS REQUIRED-



Phillips Screw Driver



Push Pin Removal Tool

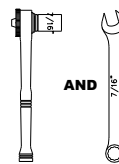

*10mm Open Wrench and
Socket Wrench*

FLAPS & BRACKETS

*(1) Flap Assembly,
Front, DS
Part #766523*

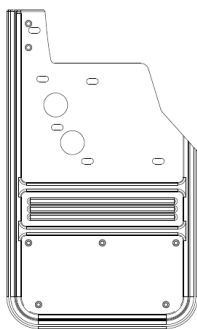

*(1) Flap Assembly
Front, PS
Part #766524*

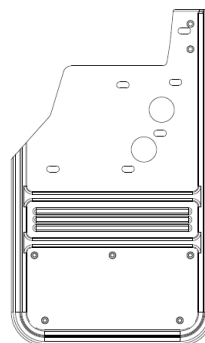

*(1) Rear Brace, DS
Part #766520*

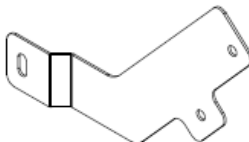

*(1) Rear Brace, PS
Part #766521*



PARTS BAG # 766514

*a) (10) Screw, Sht Metal
SS, #14-10 x 1"
Part #010048*



*b) (2) Screw, Mach.
SS, M6-35mm, Hex
Part #012028*



*c) (14) Washer, Flat
0.281" x 1", SS
Part #018028*



*d) (2) Washer, Lock
18-8SS, 1/4"
Part #024000*



*e) (2) Nut, Hex
SS, M6-1
Part # 025022*



*g) (4) Flange Nut
Serrated, Pltd. M6-1
Part # 025025*



INSTALLATION *(For ease of installation it is suggested that the wheel be removed)*

1. Before you install your Mud Flap Set, see the diagram and parts list for all necessary parts.
2. Remove the factory screws on the inner fender and push pin on the underside of the mud flap. Remove the factory mud guard and reinstall the factory push pin.
3. Install the rear brace on the existing factory bolts #1 & #2 located on the rear side of the wheel tub using (2) serrated flange nuts #025025.
4. Loosely install the mud flap to the inner fender through holes #3 to #7 using (5) sheet metal screws #010048, and (5) stainless steel washers #018028.
5. Loosely install the inner flap hole #8 to the support bracket using (1) machine screw #012028, (2) stainless steel washers #018028, (1) lock washer #024000, and (1) hex nut #025022
6. Using a bubble level or square, ensure that the mud flap is level. Viewing the truck from the back, the outer edge of the mud flap should appear parallel to the tires
7. Carefully tighten all fasteners (do not overtighten, as this can strip the factory plastic inserts), ensuring that the mud flap remains level.
8. Repeat procedure for the passenger side.

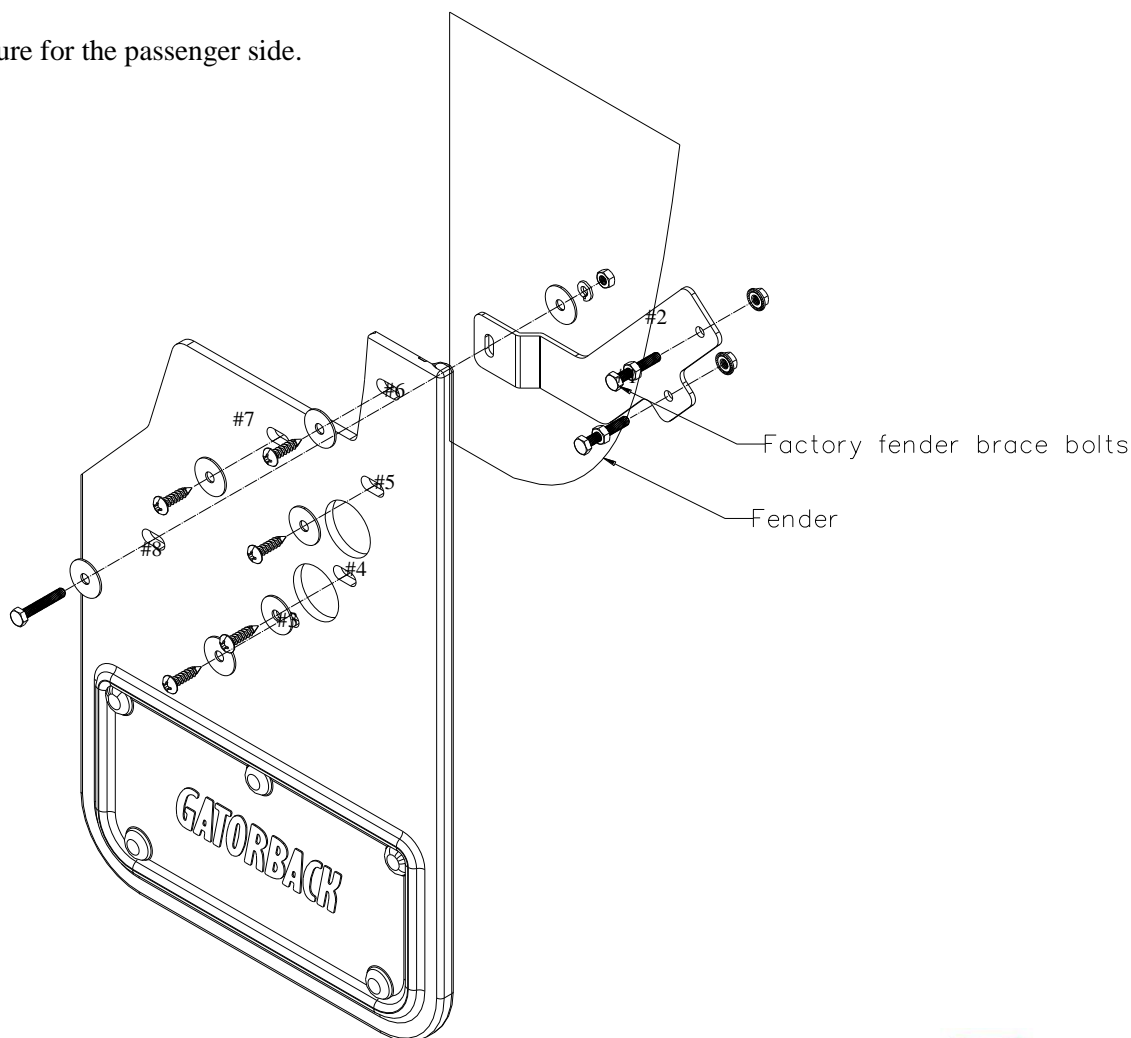

Please check out our YouTube channel to see an install video for this application.



1520 - 33 St N • Lethbridge, AB T1H 5H3 • Canada
Toll free: 1-800-661-8208 • Email: info@truckhardware.ca • www.truckhardware.ca

