



2020 GMC Sierra HD
2" Offset Mud Flap Set, Front
Mounting Diagram & Instructions
Kit# GCS200F

IMPORTANT:

Manufacturer is not responsible for negligent use of vehicle with mud flaps installed, including over-tightening of screws and bolts causing damage to vehicle or mud flaps.



TOOLS REQUIRED-

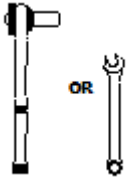

7/16" Open Wrench or
Socket Wrench



1/4" Socket Driver



T15 Torx
Bit

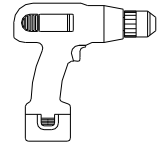

Electric or Rechargeable
Drill

FLAPS

(1) Flap Assy
Front, DS

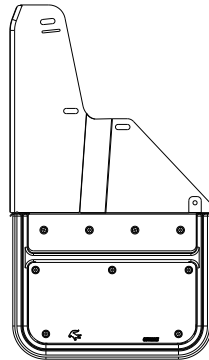

(1) Flap Assy
Front, PS

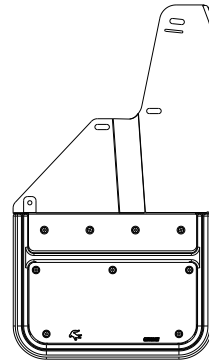

PARTS BAG # 768389

a) (2) Washer, Flat
0.281" x 1", 18g, SS,
Part #018028

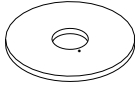

b) (4) Washer, Flat
0.203" x 1", 18g, SS,
Part #018031

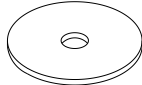

c) (2) Washer, Flat
0.437" x 1", Nylon
Part #054076

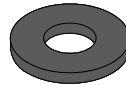

d) (2) Cap Screw, SS
1/4"-20UNC x 5/8"
Part #014006

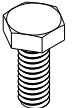

e) (4) Screw, Sheet Metal, SS
1/4" Hex Washer Head, #8-18x1"
Part # 016054

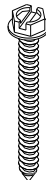

f) (1) Mud Flap Clip
Driver Side
Part # 768157

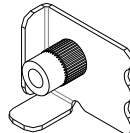

g) (1) Mud Flap Clip
Passenger Side
Part #768158

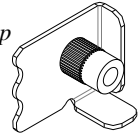

INSTALLATION *(For ease of installation it is suggested that the wheel be removed)*

1. Before you install your Mud Flap Set, see the diagram and parts list for all necessary parts. Start on the driver's side.
2. Remove factory screw from wheel well holes #5 & #6.
3. Loosely install mount clip (f) on mud flap hole #1 using a cap screw (d), stainless steel washer (a), and nylon washer (c).
4. Tuck the offset tab #4 underneath the factory plastic cap until the tab is fully engaged inside the factory plastic cap
5. Loosely secure mud flap through hole #2 into factory hole #5 using supplied sheet metal screw (e) and stainless steel washer (b).
6. Install mount clip (f) on hole #1 behind the fender lip.
7. Loosely secure mud flap through hole #3 into hole #6 using supplied screw (e) and washer (b).
8. Using a bubble level or other levelling tool, ensure that the mud flap is level. Tighten fasteners.
9. Repeat procedure for passenger side.

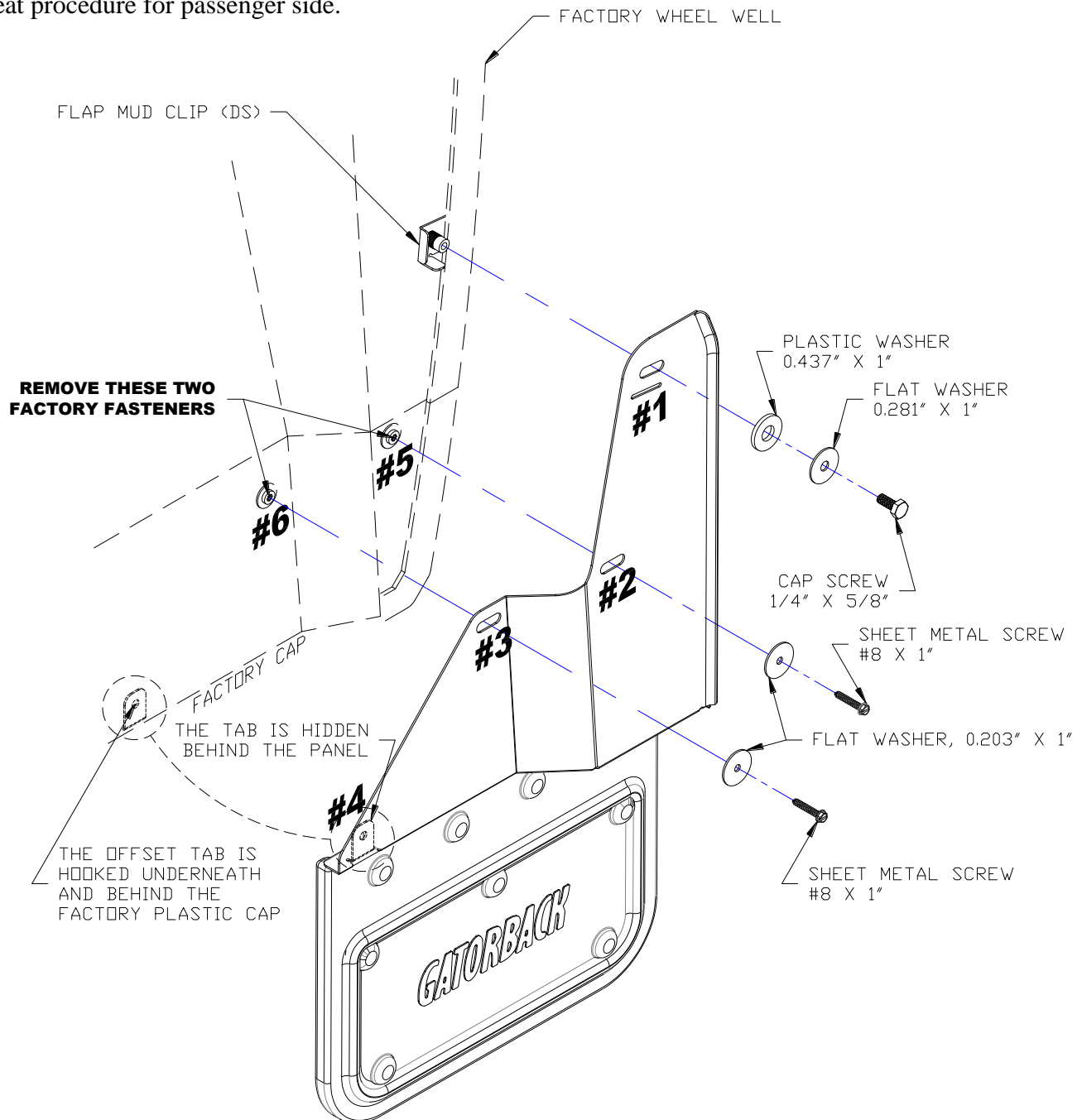



2020 GMC Sierra HD
2" Offset Mud Flap Set, Rear
Mounting Diagram & Instructions
Kit# GCS200R

IMPORTANT:

Manufacturer is not responsible for negligent use of vehicle with mud flaps installed, including over-tightening of screws and bolts causing damage to vehicle or mud flaps.



TOOLS REQUIRED-

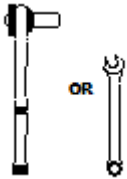

7/16" Open Wrench or
Socket Wrench

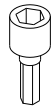

1/4" Socket Driver



T15 Torx
Bit

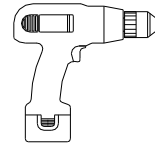

Electric or Rechargeable
Drill

FLAPS

(1) Flap Assy
Rear, DS

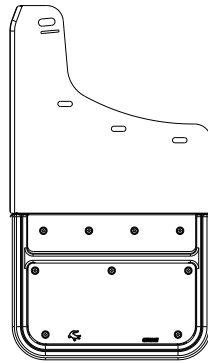

(1) Flap Assy
Rear, PS

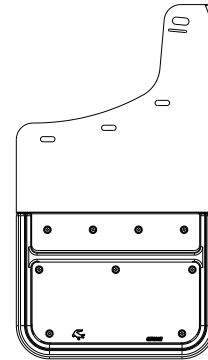

PARTS BAG # 768390

a) (2) Washer, Flat
0.281" x 1", 18g, SS,
Part #018028

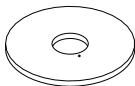

b) (6) Washer, Flat
0.203" x 1", 18g, SS,
Part #018031

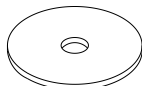

c) (2) Washer, Flat
0.437" x 1", Nylon
Part #054076



d) (2) Cap Screw, SS
1/4"-20UNC x 5/8"
Part #014006

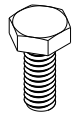

e) (6) Screw, Sheet Metal, SS
1/4" Hex Washer Head, #8-18x1"
Part # 016054



f) (1) Mud Flap Clip
Driver Side
Part # 768157

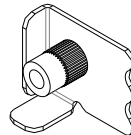

g) (1) Mud Flap Clip
Passenger Side
Part #768158

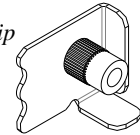

INSTALLATION *(For ease of installation it is suggested that the wheel be removed)*

1. Before you install your Mud Flap Set, see the diagram and parts list for all necessary parts. Start on the driver's side.
2. Remove factory screw from wheel well holes #5 to #7.
3. Loosely install mount clip (f) on mud flap hole #1 using a cap screw (d), stainless steel washer (a), and nylon washer (c).
4. Loosely secure mud flap through hole #2 into factory hole #5 using supplied sheet metal screw (e) and stainless steel washer (b).
5. Install mount clip (f) on hole #1 behind the fender lip.
6. Loosely secure mud flap through hole #3 into hole #6 and through hole #4 into hole #7 using supplied screws (e) and washers (b)
7. Using a bubble level or other levelling tool, ensure that the mud flap is level. Tighten fasteners.
8. Repeat procedure for passenger side.

